



Quasar

582

PARTS CATALOGUE

Issue 2 – 23.01.02



Pegasus Aviation, Elm Tree Park, Manton, Marlborough, Wiltshire SN8 1PS, UK
Telephone: +44 (0)1672 861578 Fax: +44 (0) 1672 861550
sales@pegasusaviation.co.uk www.pegasusaviation.co.uk

CONTENTS

ASSEMBLY	PAGE
General Arrangement	1
Base Tube	4
Rear Undercarriage	6
Front Undercarriage	10
Pylon	12
Rear Steering Bar	14
Front Strut	16
Seat	18
Brake System	20
Seat Belt	22
Fuel System	24
Throttle and Choke	27
Electrical and Instruments	30
Power Plant	33
Fairings	38

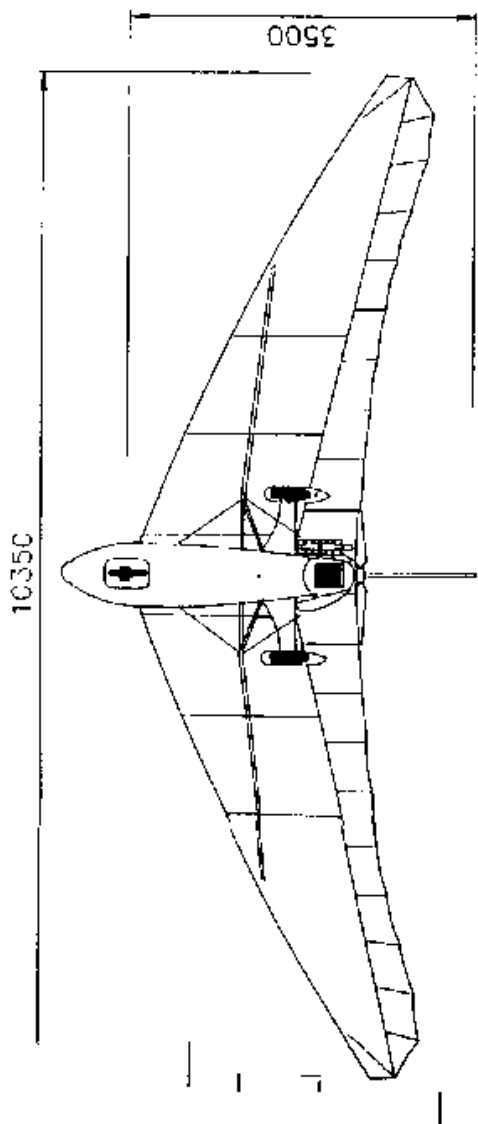
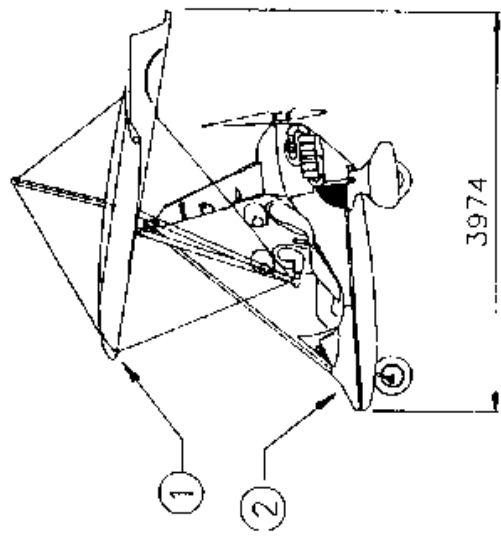
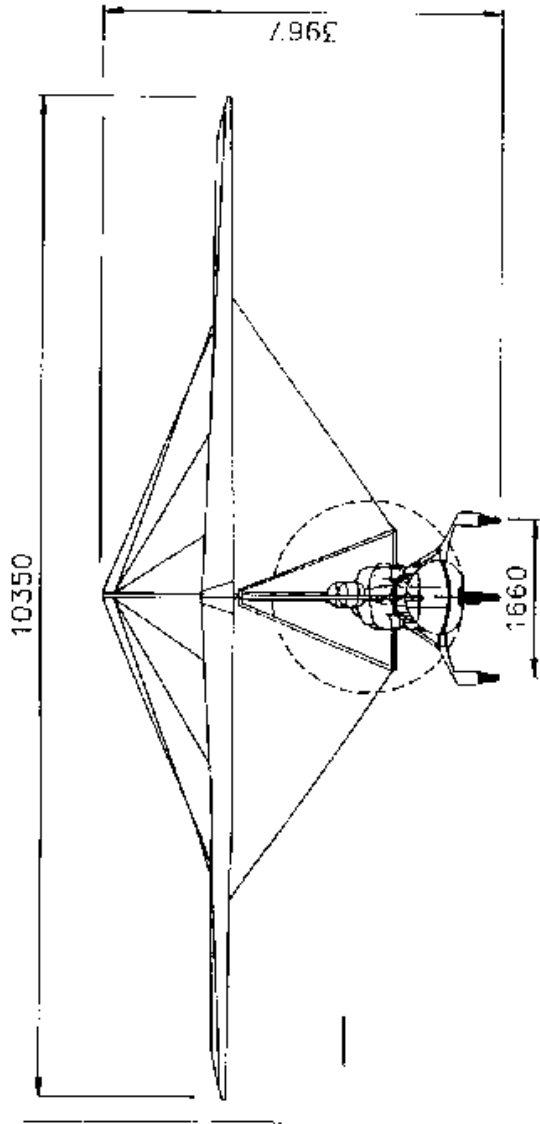

QUASAR TRIKE - 582 DITC
GENERAL ARRANGEMENT

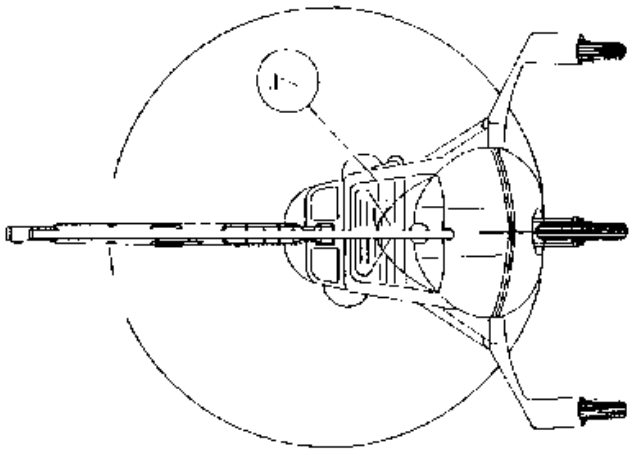
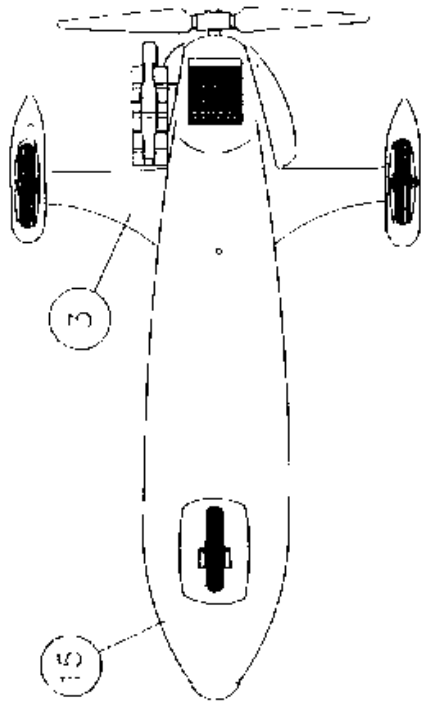
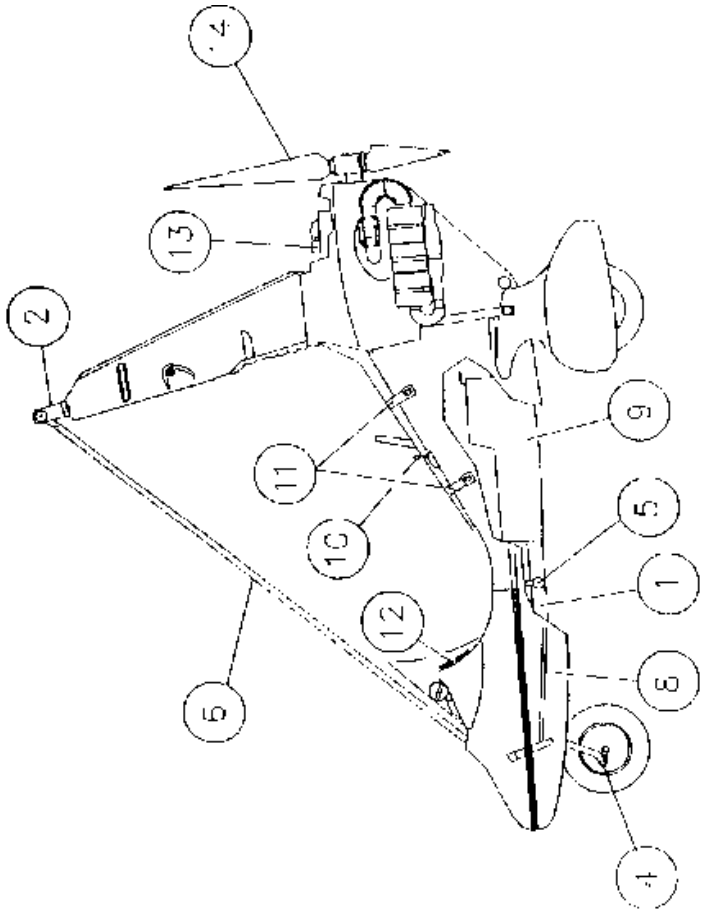

QUASAR TRIKE - 582 DITC

QUASAR TRIKE - 582 DITC

Item	Description	Qty	Part Number
1	BASE TUBE SUB ASSEMBLY	1	
2	CYLON SUB ASSEMBLY	1	
3	REAR UNDERCARRIAGE SUB ASSEMBLY	1	
4	FRONT UNDERCARRIAGE SUB ASSEMBLY	1	
5	REAR STEERING SUB ASSEMBLY	1	
6	FRONT STRUT SUB ASSEMBLY	1	
7	SEAT SUB ASSEMBLY	1	
8	BRAKE SYSTEM SUB ASSEMBLY	1	
9	FUEL SYSTEM SUB ASSEMBLY		
10	THROTTLE AND CHOKE SUB ASSEMBLY	1	
11	SEAT BELT SUB ASSEMBLY	1	
12	ELECTRICAL AND INSTRUMENT SUB ASSEMBLY	1	
13	ENGINE PLANT SUB ASSEMBLY	1	
14	PROPELLER SUB ASSEMBLY	1	
15	AIRINGS SUB ASSEMBLY	1	

BASETUBE

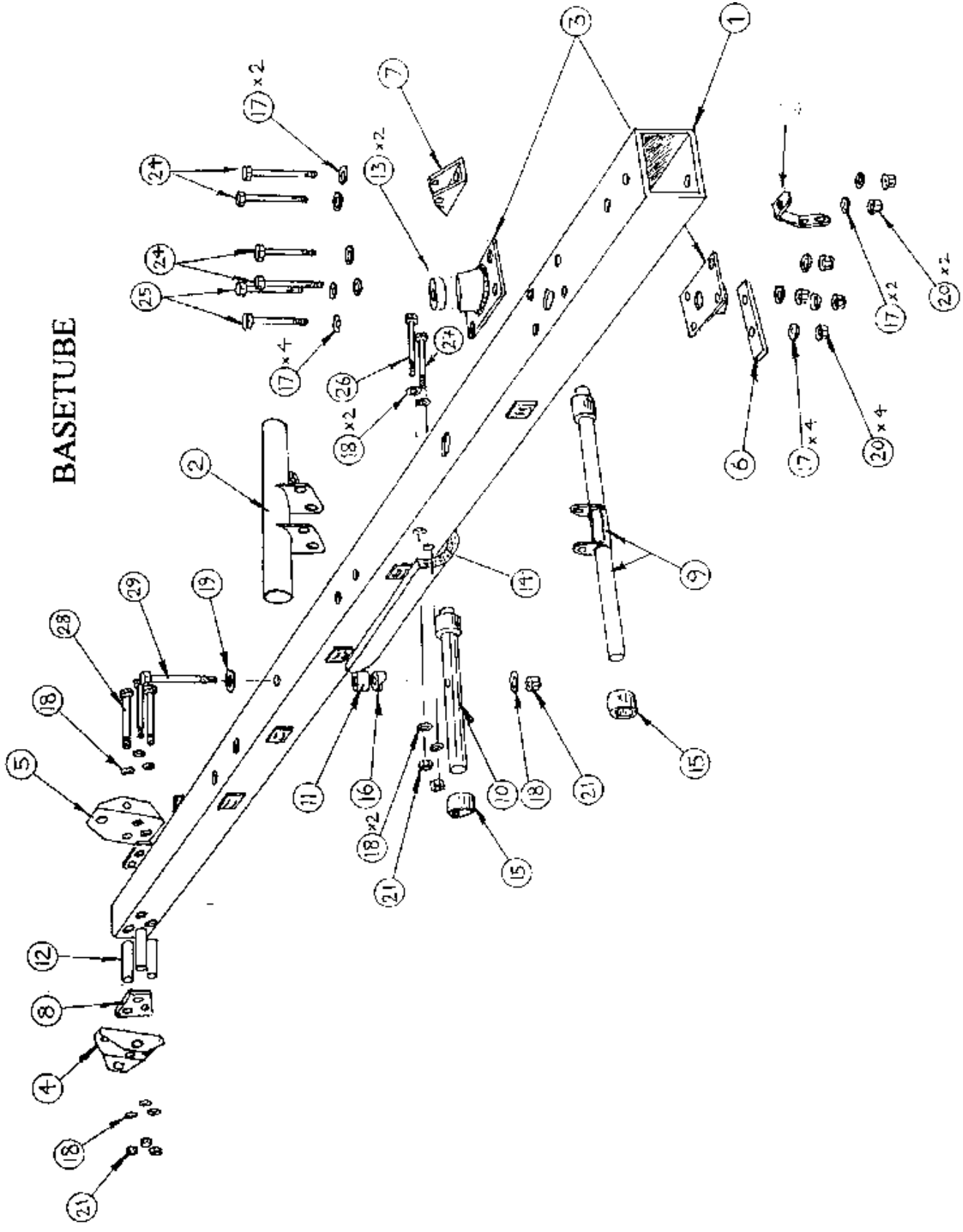

BASETUBE

Item	Description	Qty	Part Number
1	BASETUBE COMPLETE	1	TQU-11100
2	SEAT BASE BRACKET	1	TQU-13340
3	STEERING HEAD PLATE	2	TQU-19610
4	RIGHT UNDERCARRIAGE CHANNEL	1	ZCH-013
5	LEFT UNDERCARRIAGE CHANNEL	1	ZCH-014
6	STEERING STOP	1	ZMP-019
7	FRONT STRUT CHANNEL LOWER	1	ZCH-012
8	UNDERCARRIAGE CHANNEL SPACER	2	ZMP-022
9	FUEL TANK BRACKET COMPLETE	1	TQU-17610
10	FUEL TANK REAR SUPPORT TUBE	1	TQU-17620
11	FUEL TANK REAR SUPPORT SPACER	1	ZMP-032
12	UNDERCARRIAGE CHANNEL COMPRESSION BUSH	3	ZSP-034
13	BEARING	2	BEA-BB-2
14	PIPE LAGGING (0.58m)		PTM19-001
15	RADIATOR HOSE Umm)	4	EFTC-7
16	PLASTIC SADDLE	1	PMS-M8-11
17	WASHER	12	FW4-T3
18	WASHER	11	FWM8-B
19	WASHER	1	FW5-10
20	NYLOCK NUT	6	FNM6-NT
21	NYLOCK NUT	6	FNM8-NT
24	HEX BOLT	4	FBM6-80
25	HEX BOLT	2	FBM6-85
26	HEX BOLT	1	FBM8-80
27	HEX BOLT	1	FBM8-85
28	HEX BOLT	3	FBM8-100
29	HEX BOLT	1	FBM8-120

REAR UNDERCARRIAGE

SHEET 1 of 2

* OMIT ITEMS 18,30,31
FOR 582 QUASAR
(FIT LOWER BODY M.D.G.
MOUNTING 'FARS' IN PLACE
OF ITEMS 30,31)

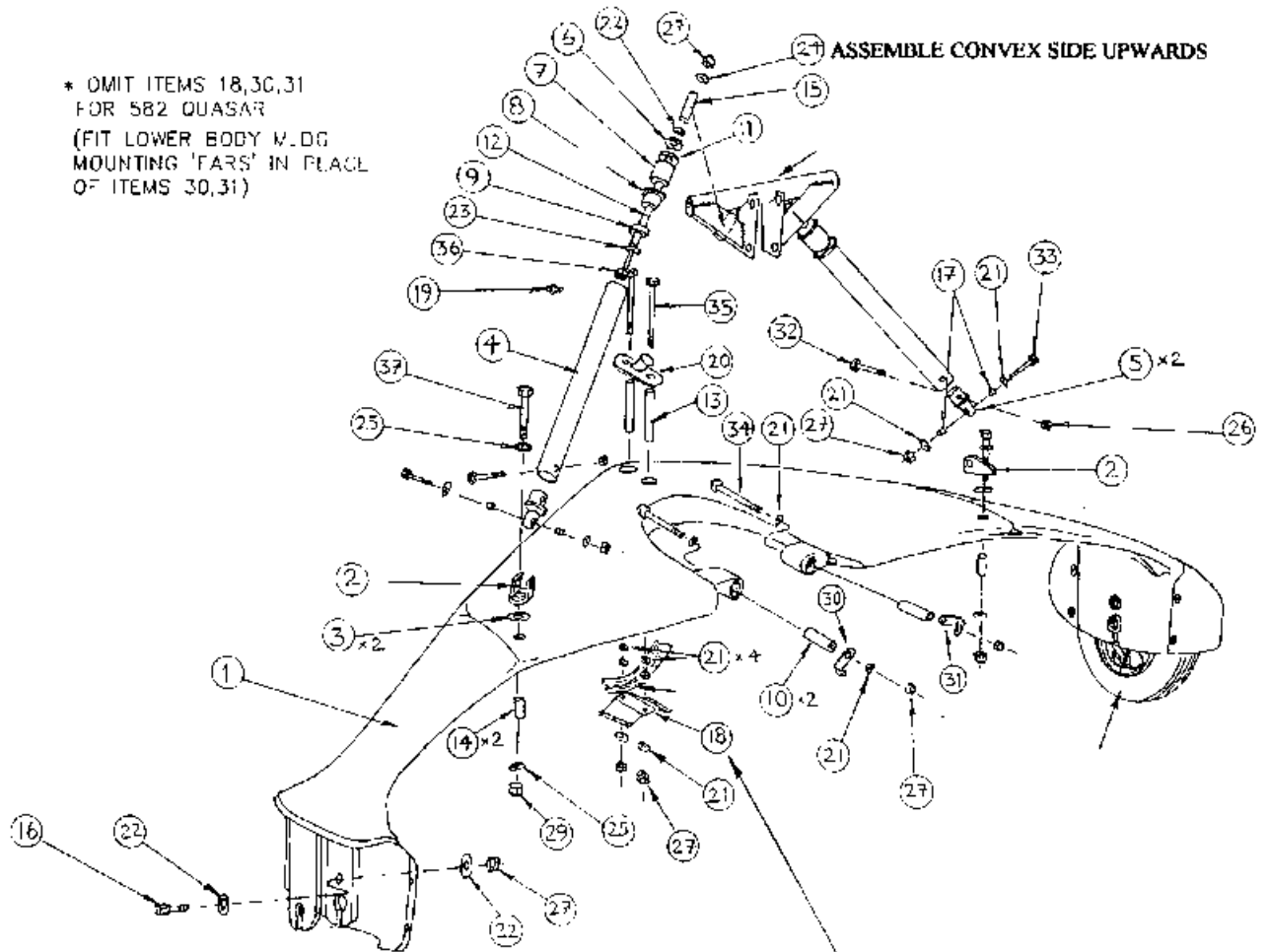

REAR UNDERCARRIAGE

SHEET 2 of 2 - GRIMECA WHEEL ASSEMBLY

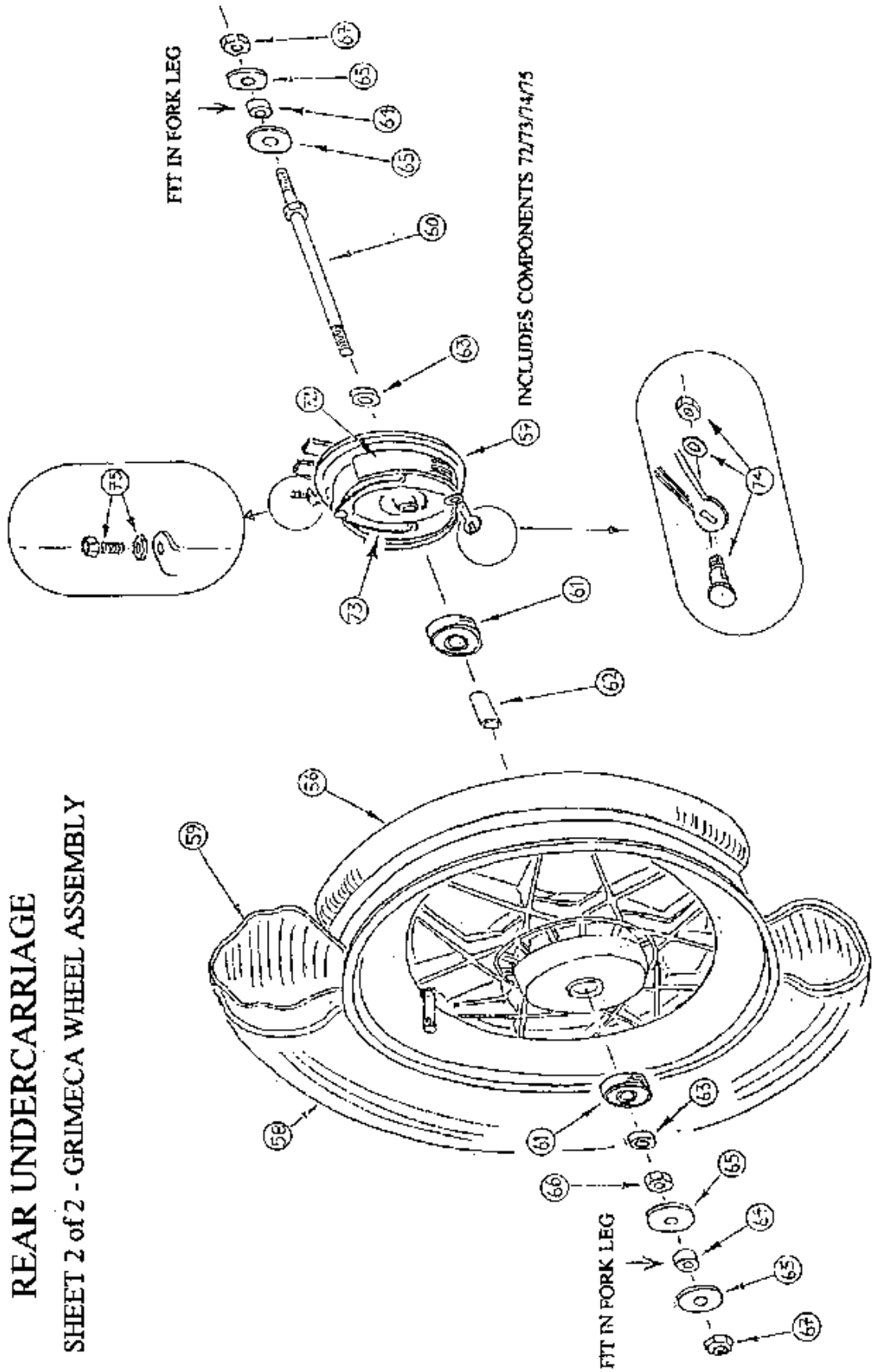

REAR UNDERCARRIAGE

Item	Description	Qty	Part Number
1	REAR UNDERCARRIAGE COMPLETE	1	TQU-14100
2	SIDE STRUT CHANNEL	2	ZCH-015
3	NYLON WASHER	2	FWP-002
4	UNDERCARRIAGE SIDE STRUT	2	TQU-14230
5	SIDE STRUT LOWER CONNECTOR	2	ZKN- 119
6	REAR SUSPENSION TOP CUP	2	ZMA-029
7	REAR SUSPENSION RUBBER	2	ZMP-039
8	REAR SUSPENSION TOP HAT BEARING	2	ZMA-028
9	REAR SUSPENSION STOP	2	ZMP-038
10	UNDERCARRIAGE INNER PIVOT BEARING	2	ZMP-024
11	PRELOADING SPACER	2	ZMP-048
12	REAR SUSPENSION SLIDER	2	ZSP-038
13	UNDERCARRIAGE CENTRE COMPRESSION BUSH	2	ZSP-035
14	UNDERCARRIAGE SIDE COMPRESSION BUSH	2	ZSP-036
15	SIDE STRUT TOP CONNECTION BUSH	2	ZMP-029
16	BRAKE TORQUE SPIGOT	2	ZMS-131
17	BEARING	4	BEA-BB4
18	REAR SUPPORT BRACKET		
19	STRAIGHT GREASE NIPPLE	2	FGN-001
20	FOLD DOWN SUPPORT	1	TOU-14350
21	WASHER	14	FWM8-11
22	WASHER	6	FW5-10
23	WASHER	2	FW5-14
24	BELVILLE WASHER	2	FWM8-BEL
25	WASHER	4	FWM10-B
26	NYLOCK NET	2	FNM6-NT
27	NYLOCK NUT	10	FNM8-NT
28	SEATBELT CLAMPING STRIP	1	ZMA-026
29	NYLOCK NUT	2	FNM10-NT
30	REAR BODY STABILISER BRACKET - LEFT	1	ZMA-030
31	REAR BODY STABILISER BRACKET - RIGHT	1	ZMA-031
32	HEX BOLT	2	FBM6-50
33	HEX BOLT	2	FBM8-50
34	HEX BOLT	2	FBM8-90
35	HEX BOLT	2	FBM8- 150
36	HEX BOLT	2	FBM8-160
37	HEX BOLT	2	FBMIO-85
56	WHEEL HUB	2	WW-003
57	BRAKE HUB ASSEMBLY	2	TQU- 19210
58	TYRE-4PLY	2	WTY-003
59	INNER TUBE	2	WTU-002
60	WHEEL AXLE (REAR)	2	WA-005

Item	Description	Qty	Part Number
61	BEARING	4	BEA-BB-5
62	BEARING SPACER	2	ZMA-032
63	WHEEL SPACER	4	ZMA-033
64	KEYHOLE BUSH	4	ZSP-029
65	WASHER	8	FWM12-C
66	FULL NUT	2	FNM12-GS
67	NYLOCK NUT	4	FNM12-NT
70	REAR WHEEL ASSEMBLY		TQU-19205
71	REAR WHEEL, TYRE, BRAKE HUB ASSEMBLY		TQU-19200
72	BRAKE SHOE		WBS-001
73	BRAKE RETURN SPRING		HS-005
74	CABLE CLAMP ASSEMBLY		JAD-004
75	CABLE ADJUSTER ASSEMBLY		JAD-003

FRONT UNDERCARRIAGE

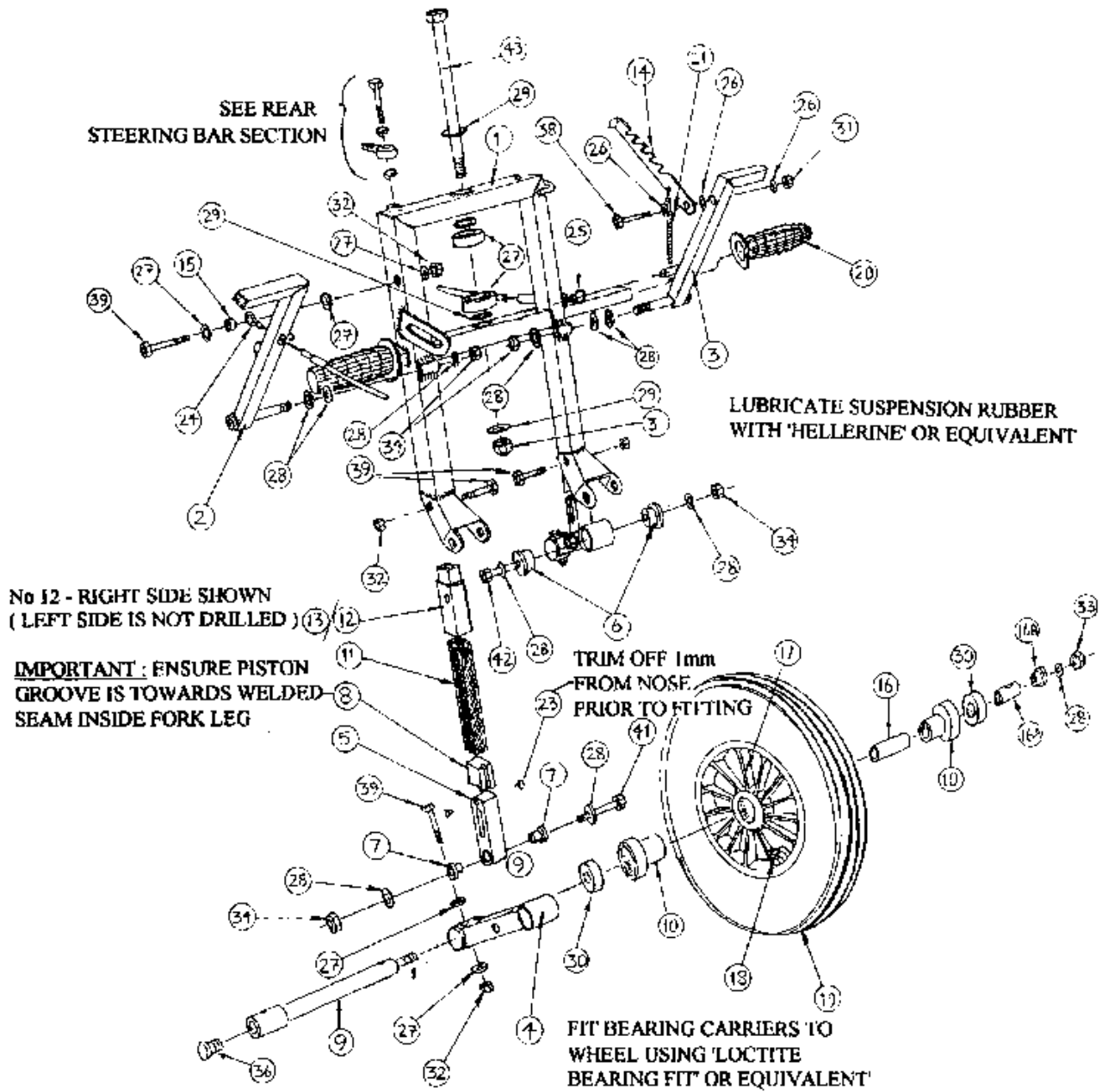

FRONT UNDERCARRIAGE

Item	Description	Quantity	Part Number
1	FRONT FORKS	1	TQU-19510
2	THROTTLE PEDAL	1	TQU-19590
3	BRAKE PEDAL	1	TQU-19592
4	TRAILING LINK	2	TQU-19520
5	PUSHROD	2	ZMA-024
6	TRAILING LINK BEARING	4	ZMP-030
7	PUSHROD BEARING	4	ZMP-034
8	PISTON	2	ZMP-033
9	FRONT WHEEL AXLE	1	ZMS-161
10	BEARING CARRIER	2	ZMA-048
11	FRONT SUSPENSION RUBBER	2	ZMP-037
12	FRONT SUSPENSION PACKER (LEFT)	1	ZMP-026
13	FRONT SUSPENSION PACKER (RIGHT)	1	ZMP-027
14	PARKING BRAKE LEVER	1	ZMS-119
15	THROTTLE CABLE BUSH	1	ZSP-031
16	BEARING SPACER	1	ZMA-051
16A	BEARING ADJUSTMENT TUBE	1	ZMA-053
16B	BEARING ADJUSTMENT CAP	1	ZMA-052
17	HUFA WHEEL	1	WW-006
18	INNER TUBE	1	WTU-003
19	TYRE	1	WTY-003
20	FOOTREST RUBBER	2	PMM-007
21	RETURN SPRING	1	HS-004
22	BEARING	2	BEA-BB-2
23	PUSH CLIP	4	FMPC-001
24	THROTTLE CABLE		
25	BRAKE CABLE		
26	WASHER	3	FWM5-11
27	WASHER	7	M4-T3
28	WASHER	15	FWM8-11
29	WASHER	4	FWMI0-B
30	BEARING	2	BEA-1313-6
31	NYLOCK NUT	1	FNM5-NT
32	NYLOCK NUT	5	FNM6-NT
33	NYLOCK NUT	1	FNM6-NP
34	NYLOCK NUT	6	FNM5-NT
35	NYLOCK NUT	1	FNMI0-NT
36	BLACK END PLUG	1	PEP6-001
38	F1EX HT BOLT	1	FBM5-30
39	HEX HT BOLT	5	FBN16-40
41	BOLT	2	ZMF-08
42	HEX HT BOLT	2	FBM8-55
43	F1EX HT BOLT	1	FBMI0-180

PYLON

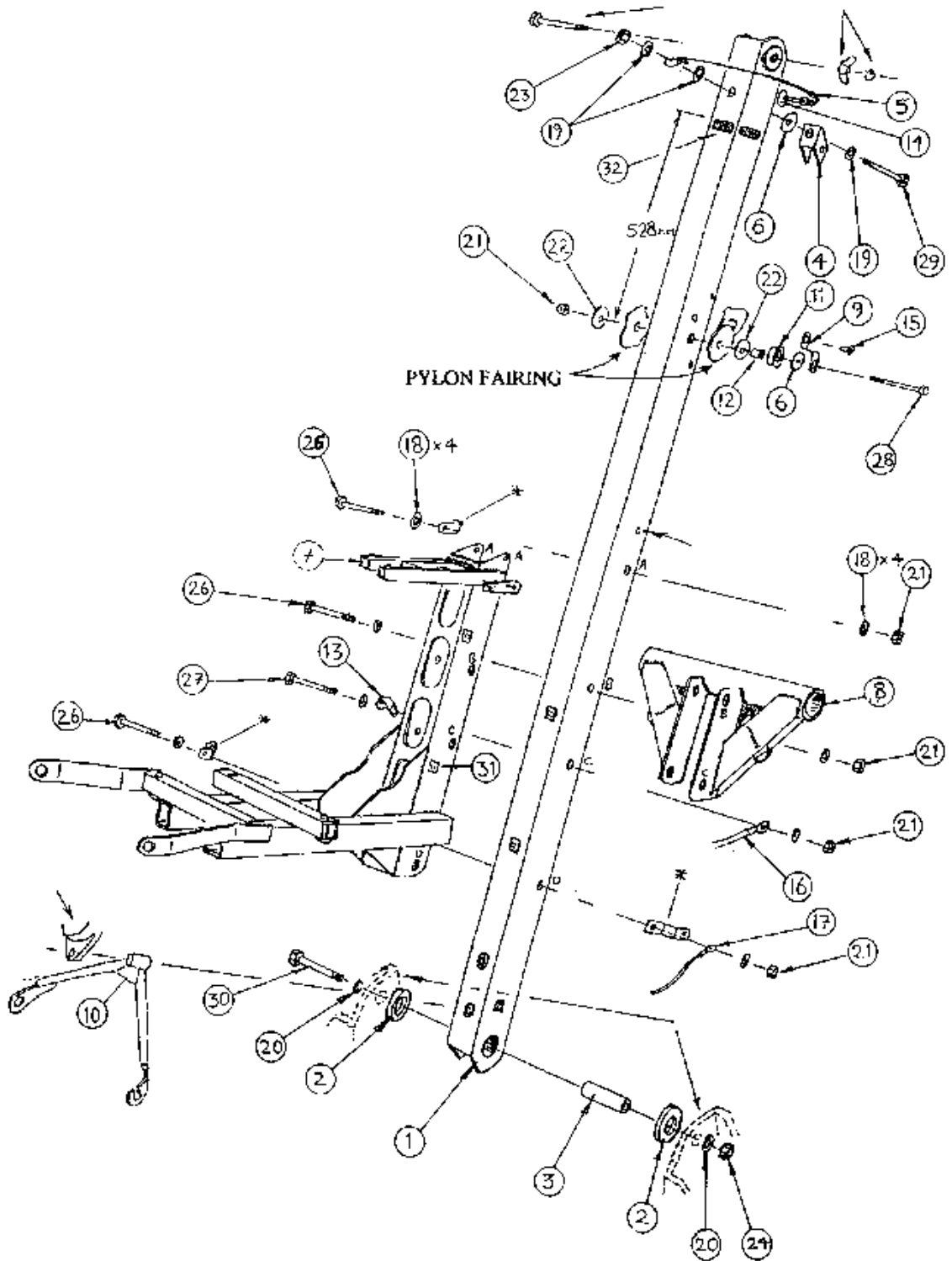

PYLON

Item	Description	Quantity	Part Number
1	PYLON COMPLETE	1	TQP-10100
2	PYLON LOWER FACE BEARING	2	ZNW-018
3	PYLON LOWER PIVOT BUSH	1	ZMP-017
4	FRONT STRUT CHANNEL UPPER	1	ZCH-0 11
5	UPPER KEEP PIN ASSEMBLY	1	TQU-10250
6	WASHER BEARING	2	ZMP-013
7	ENGINE BRACKET	1	TQA-15312
8	SEAT BRACKET UPPER	1	TQU-13330
9	PULLEY GUARD	1	ZMS-120
10	LOWER RADIATOR BRACKET	1	TQA-15170
11	ALUMINIUM PULLEY	1	RP-11
12	ALUMINIUM PULLEY BUSH	1	RP-12
13	'P' CLIP	1	HCC-005
14	SAFETY RING	1	FPSR-001
15	MONEL POP RIVET	1	FR6-12-001
16	EARTH STRIP	1	LC-002
17	MAIN SIGNAL WIRING CABLE		
18	WASHER	8	FW4M
19	WASHER	3	MM8-B
20	WASHER	2	FWMI0-B
21	NYLOCK NUT	5	FW6-NT
22	WASHER	2	FW5-10
23	NYLOCK NUT	1	FW8-NP
24	NYLOCK NUT	1	FNMI0-NT
26	HEX BOLT	3	FBM6-80
27	HEX BOLT	1	FBM6-85
28	HEX BOLT	1	FBM6-90
29	HEX BOLT	1	FBM8-85
30	HEX BOLT	1	FBMI0-100
31	CABLE TIE MOUNT	4	HTM-001
32	NEOPRENE SEALING STRIP (4 x 50mm)		PSS-001

REAR STEERING BAR

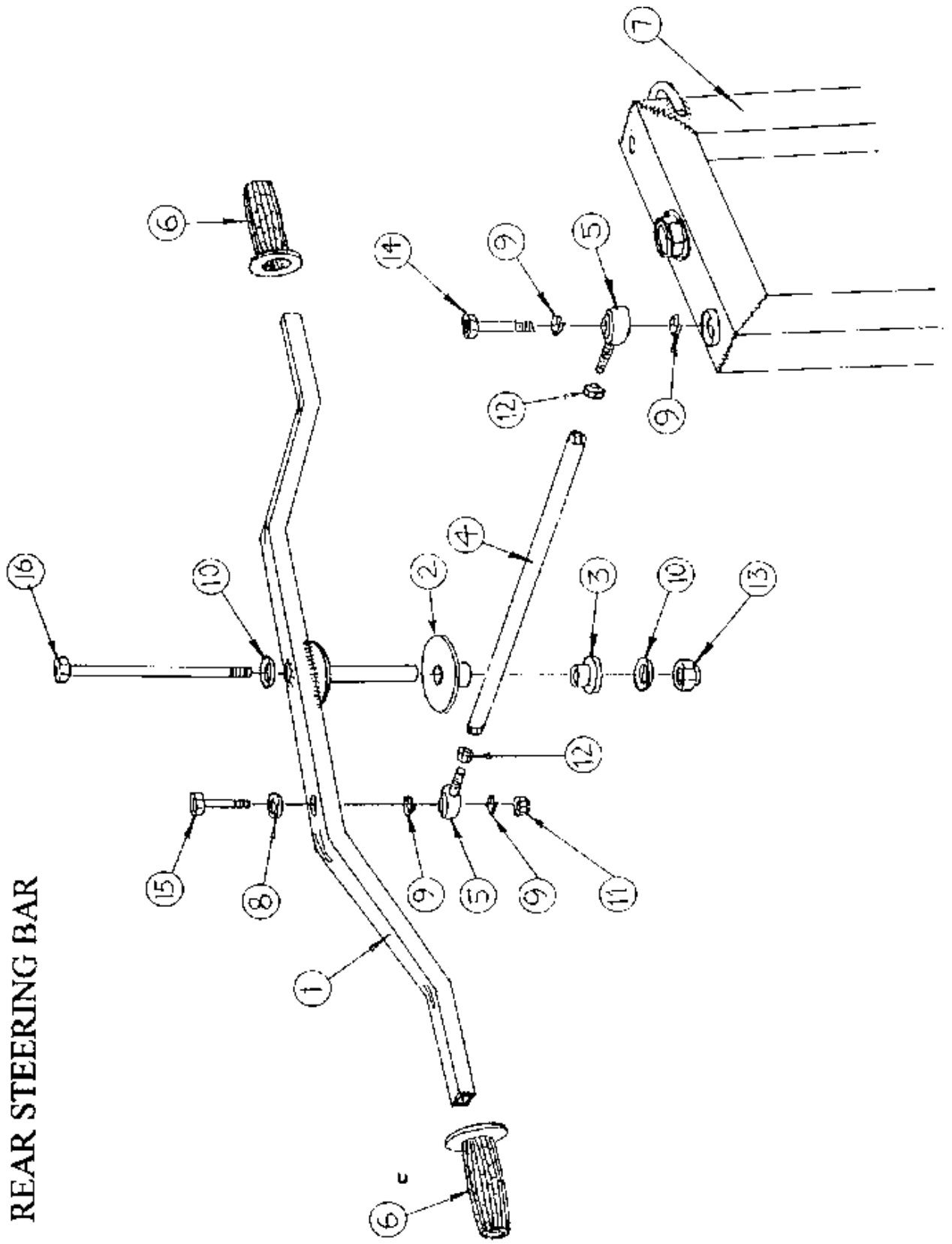

REAR STEERING BAR

Item	Description	Quantity	Part Number
1	REAR STEERING BAR	1	TQU-19810
2	UPPER BEARING PAD	1	ZMP-020
3	LOWER BEARING	1	ZMP-021
4	STEERING LINK	1	TQU-19710
5	ROD END BEARING	2	BEA-RE-1
6	FOOTREST RUBBER	2	PMM-007
8	WASHER	1	FW4-T3
9	SPRING WASHER	4	MM6-SW
10	WASHER - FORM B	2	FWM8-B
11	NYLOCK NUT	1	FNM6-NT
12	PLAIN FULL NUT	2	FNM6-G8
13	NYLOCK NUT	1	FNM8-NT
14	HEX BOLT	1	FBM6-25
15	HEX BOLT	1	FBM6-40
16	HEX BOLT	1	FBM8-110

FRONT STRUT

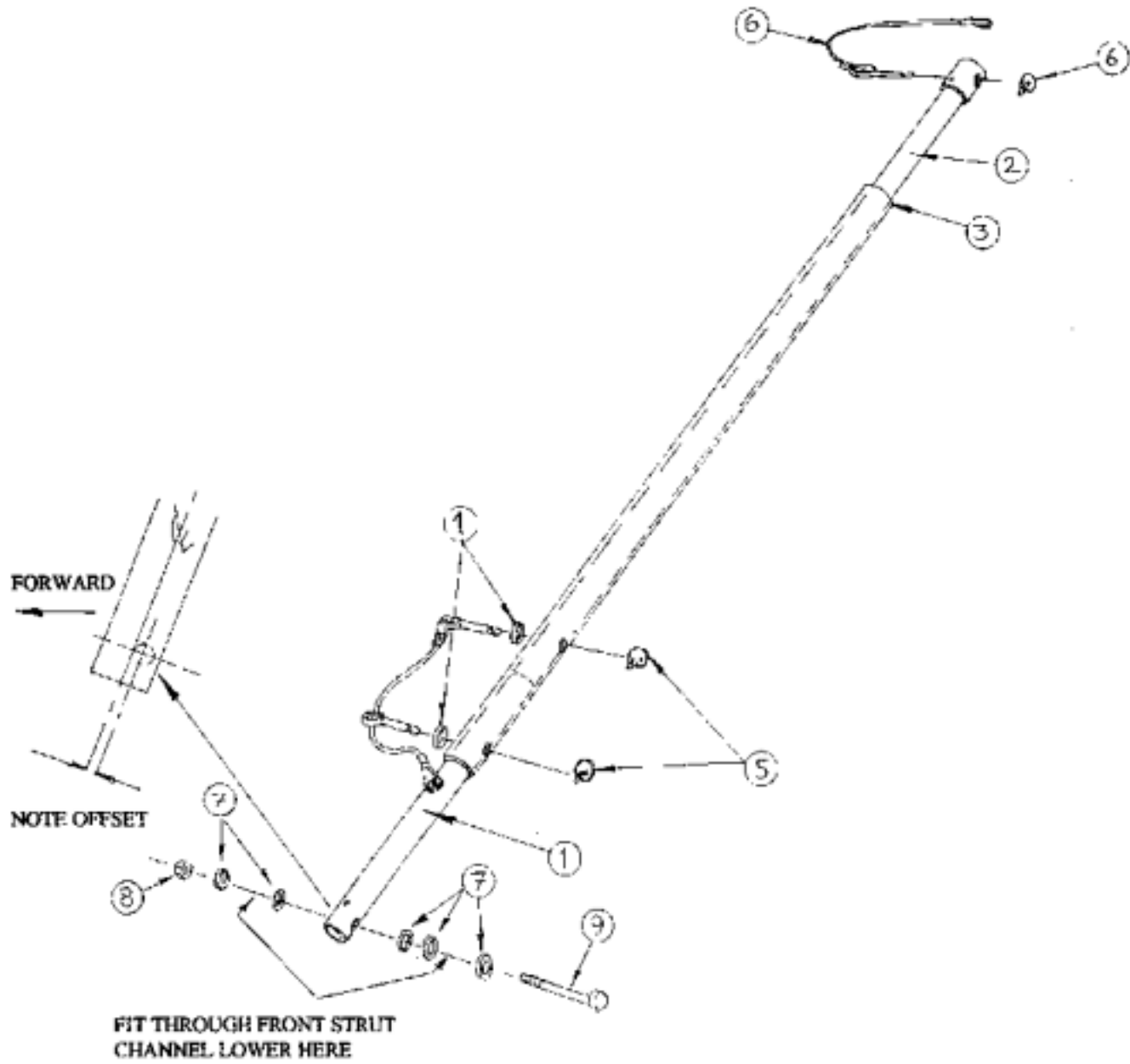

FRONT STRUT

Item	Description	Quantity	Part Number
1	FRONT STRUT LOWER COMPLETE	1	TQU-12200
2	FRONT STRUT UPPER COMPLETE	1	TQU-12400
3	FRONT STRUT OVERSLEEVE	1	TQU-12100
4	SKIFFY RING	2	PMC-SB6
5	SAFETY RING	2	FPSR-001
6	UPPER KEEP PIN ASSEMBLY		
7	WASHER	5	FW4-T3
8	NYLOCK NUT	1	FNU4-NT
9	AIRCRAFT HEX BOLT	1	FBA4-17A

SEAT

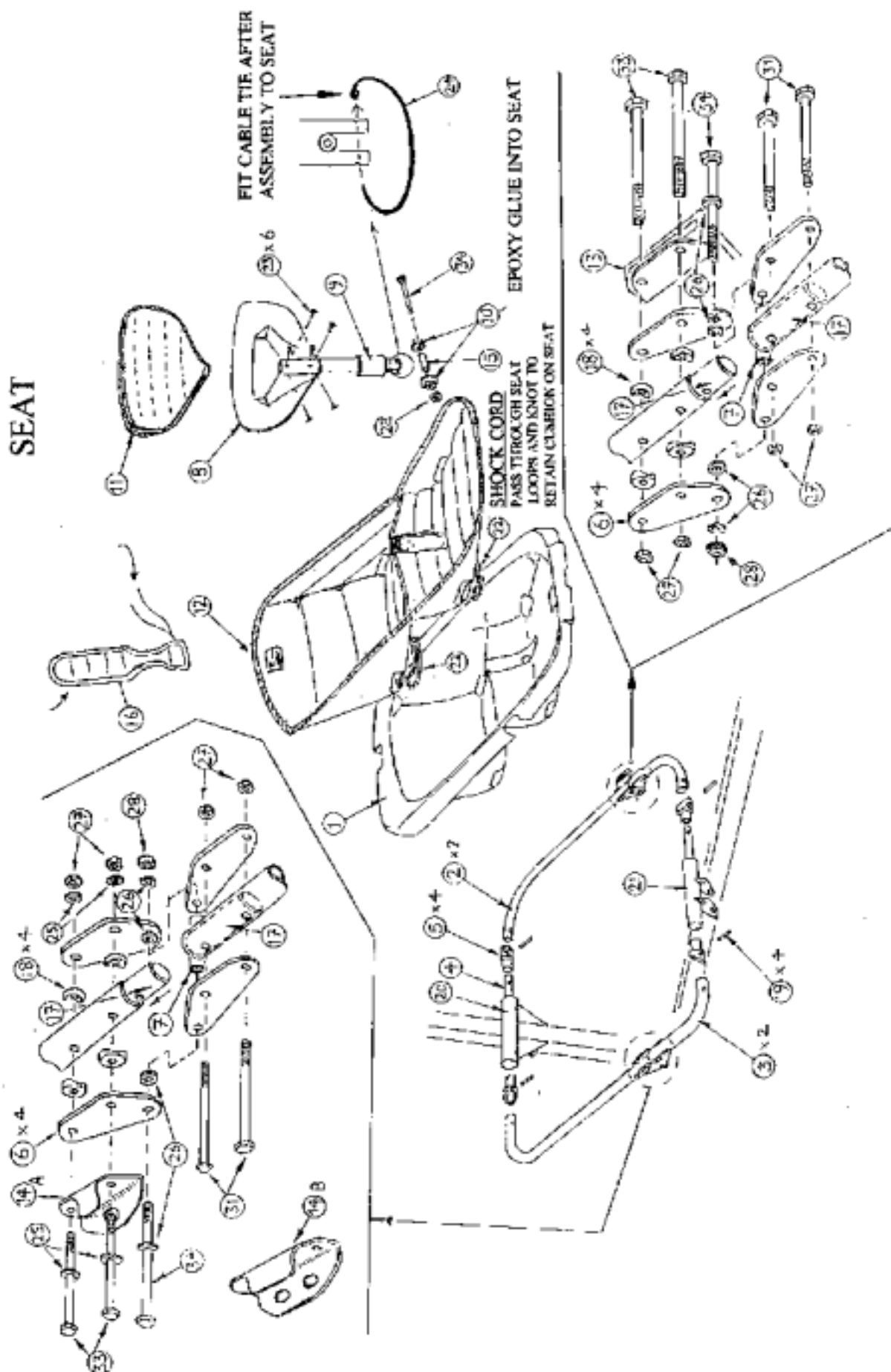

SEAT

Item	Description	Quantity	Part Number
1	SEAT MOULDING		TQU-13212
2	UPPER SEAT FRAME TUBE	2	TQU-13310
3	LOWER SEAT FRAME TUBE	2	TQU-13320
4	SEAT FRAME LINK TUBE	2	ZAU-019
5	SEAT FRAME PIVOT BEARING	4	ZMP-023
6	SEAT HINGE PLATE	8	ZPL-002
7	SEAT HINGE PLATE SPACER TUBE	2	ZSP-030
8	BACKREST	1	TQU-13220
9	BACKREST TUBE	1	TQU-13225
10	BACKREST PIVOT BUSH SPACER	2	ZMP-035
11	BACKREST CUSHION COVER		TQU-13120
12	SEAT CUSHION	1	TQU-13110
13	HAND THROTTLE CASE		
14A	IGNITION SWITCH BRACKET (SINGLE)	1	ZMS-132
14B	IGNITION SWITCH BRACKET (DUAL)	1	ZMS-150
15	BACKREST PIVOT BUSH	1	ZSP-033
16	PASSENGER HEAD CUSHION	1	TQU-13130
17	SEAT TUBE INSERT	4	ZIN-006
18	PLASTIC SADDLE	8	PMS-M6-11
19	CARBON STEEL PIN	4	FPRP-002
20	SEAT BRACKET UPPER		
21	SEAT BASE BRACKET		
22	SHOCK CORD		VSC3-001
23	POP RIVET	6	FR6-12-001
24	CABLE TIE	1	HTW-001
25	WASHER	4	FWM5-B
26	WASHER	8	FW4-T3
27	NYLOCK NUT	8	FNM5-NT
28	NYLOCK NUT	3	FNM6-NT
31	HEX BOLT	4	FBM5-40
33	HEX BOLT	4	FBM5-50
34	HEX BOLT	3	FBM6-50

BRAKE SYSTEM

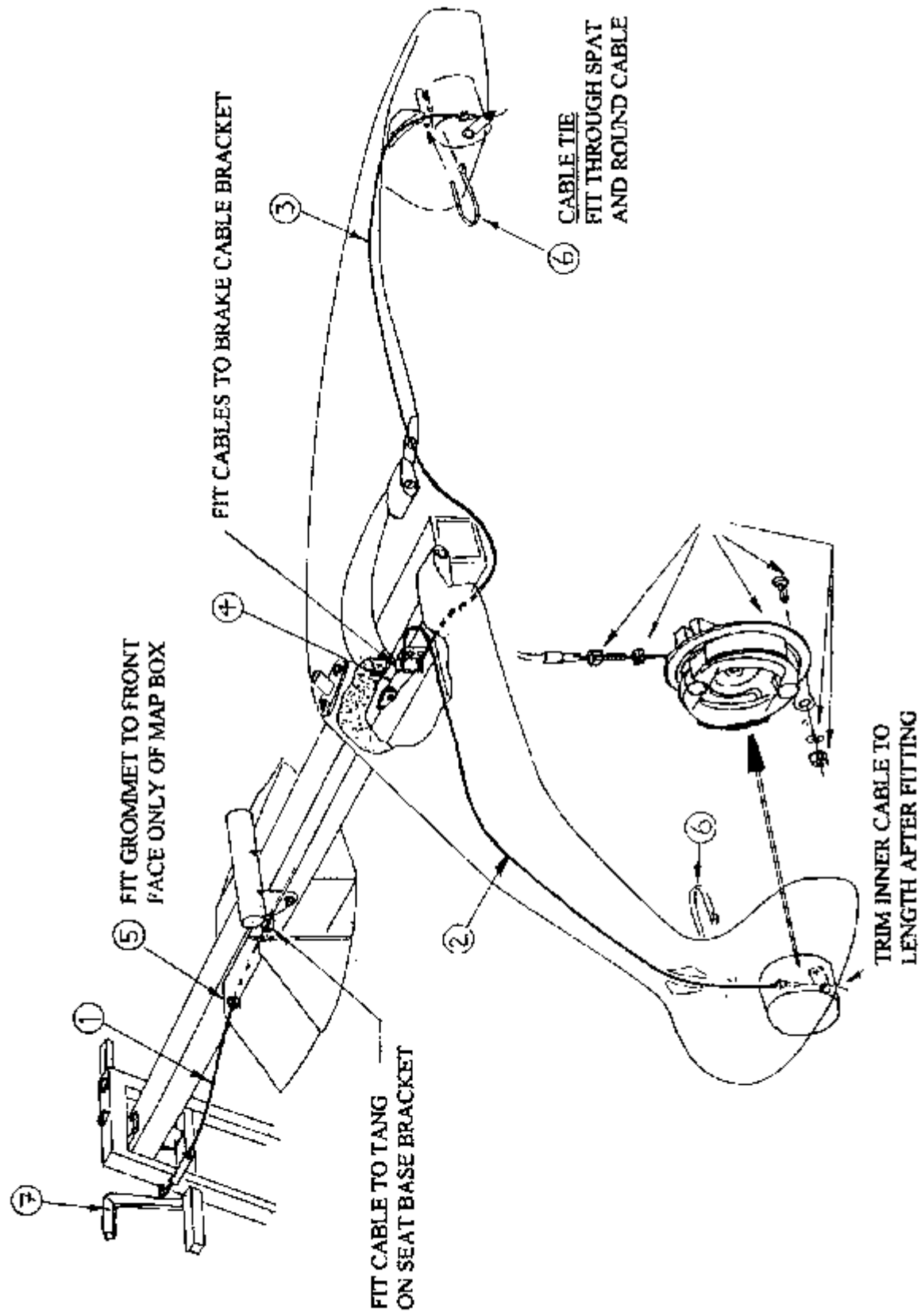

BRAKE SYSTEM

Item	Description	Quantity	Part Number
1	BRAKE CABLE - FRONT SECTION	1	TQU-16410
2	BRAKE CABLE OUTER - LEFT REAR	1	TQU-16422
3	BRAKE CABLE OUTER - RIGHT REAR	1	TQU-16424
4	BRAKE CABLE INNER - REAR	1	TQU-16426
5	GROMMET	1	PMM-014
6	CABLE TIE	2	HTW-003
7	BRAKE PEDAL		

SEAT BELT

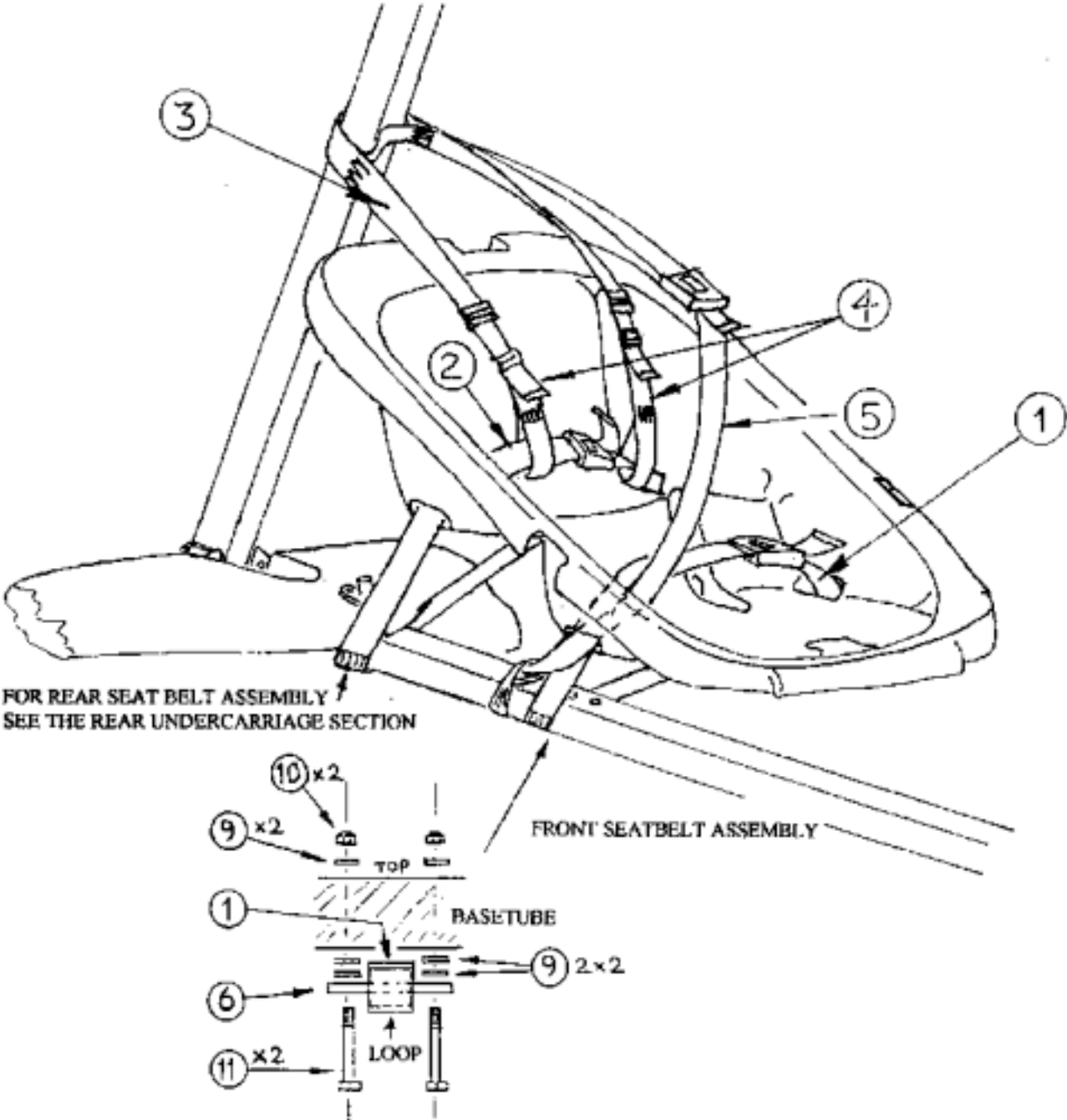

SEAT BELT

Item	Description	Quantity	Part Number
1	FRONT LAP BELT	1	TQU-13410
2	REAR LAP BELT	1	TQU-13420
3	SHOULDER YOKE	1	TQU-13442
4	ADJUSTMENT BELT	2	TQU-13430
5	FRONT SHOULDER BELT - LOWER	1	TQU-13441
6	SEATBELT CLAMPING STRIP	1	ZMA-026
9	WASHER	6	FW4-T3
10	NYLOCK NUT	2	FNM6-NT
11	HEX BOLT	2	FBM6-75

FUEL SYSTEM

SHEET 1 of 2

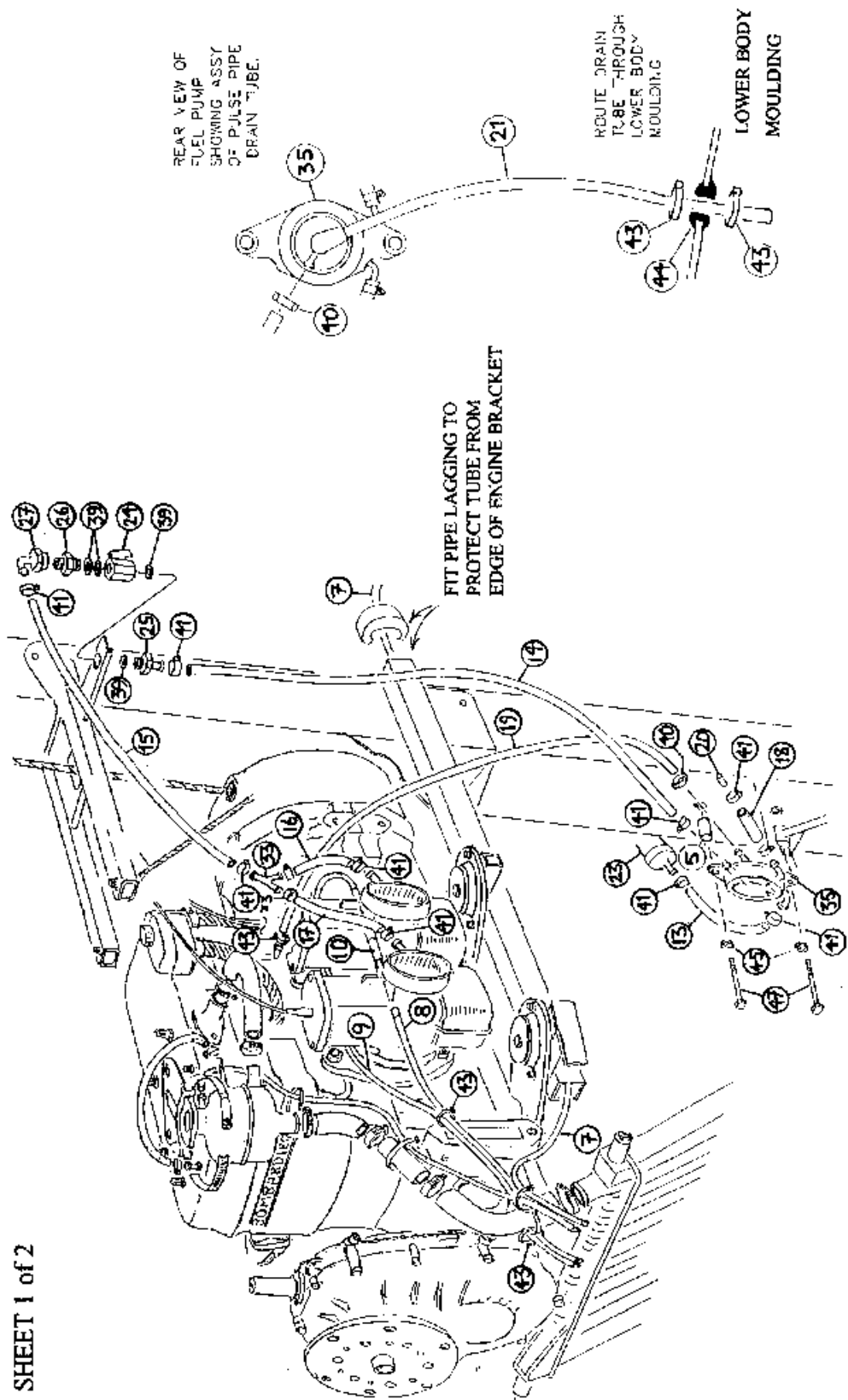

FUEL SYSTEM

Item	Description	Qty	Part Number
1	FUEL TANK	1	EFT-4
3	FUEL GAUGE	1	TQU-17120
4	FUEL TANK PICK UP PIPE	1	TQA-17112
5	FUEL PUMP SPACER	1	TOU-17550
7	VENT LINE (FUEL TANK TO ATMOSPHERE)	1	TQA-17245
8	VENT LINE (REAR CARBURETTOR TO ATMOSPHERE)	1	TQA-17246
9	VENT LINE (FRONT CARBURETTOR TO ATMOSPHERE)	1	TQA-17247
10	VENT LINE (CARBURETTOR LINK)	1	T2A-17248
11	FUEL LINE (TANK TO PRIMER BULB)	1	TQA-17210
12	FUEL LINE (PRIMER BULB TO FILTER)	1	TQA-17226
13	FUEL LINE (FILTER TO PUMP)	1	TQU-17210
14	FUEL LINE (PUMP TO TAP)	1	TQU-17220
15	FUEL LINE (TAP TO Y PIECE)	1	TQA-17226
16	FUEL LINE (Y PIECE TO FRONT CARB)	1	TQA-17227
17	FUEL LINE (Y PIECE TO REAR CARB)	1	TQA-17228
18	FUEL PUMP BLANKING PIPE	1	TQU-17235
19	PULSE PIPE	1	TQU-17230
20	FUEL PUMP BLANKING ROD	1	EFPBR-1
21	PULSE PIPE DRAIN TUBE	1	TQU-17250
22	PRIMER BULB	1	EFLC-6
23	INLINE FUEL FILTER	1	EFF-1
24	FUEL TAP	1	EFLC-3
25	THREADED SPIGOT	1	EFLC-2
26	THREADED CONNECTOR	1	EFLC-4
27	FEMALE SPIGOT	1	EFLC-5
32	DRAIN PLUG	1	EFTC-5
33	Y PIECE FUEL LINE CONNECTOR	1	ZMS-007
34	FUEL TANK STRAINER	1	EFF-5
35	FUEL PUMP	1	ES-994485
36	NITRILE O RING	1	EFTC-8
39	FIBRE WASHER.	5	EFW-1
40	101 CLIP	2	HCI8-001
41	HOSE CLIP	16	HCM12-001
43	CABLE TIE	5	HTW-002
44	STANDARD GROMMET	1	PMM-014
45	SPRING WASHER	5	FWM6-SW
46	SOCKET BEAD CAP SCREW	3	FCM6-10
47	HEX BOLT	2	FBM6-50

SHEET 2 of 2 - CABLES TO ENGINE

CHOKE LEVER ASSEMBLY

FRONT VIEW (EXPLODED)

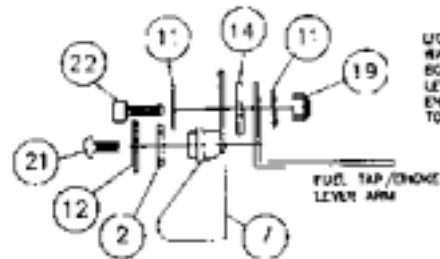

LIGHTLY GREASE NYLON
WASHER AND TIGHTEN
BOLT SUCH THAT THE
LEVER IS JUST FREE
ENOUGH TO RETURN
TO STOP

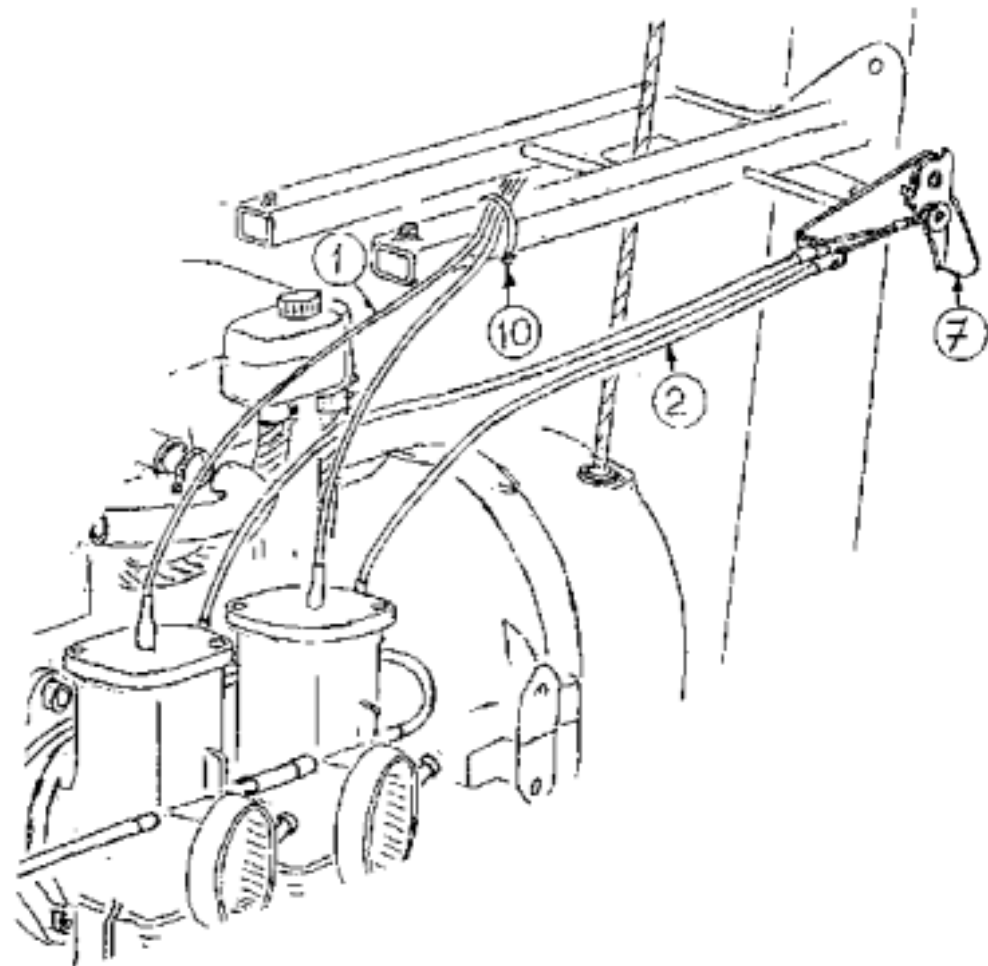

THROTTLE AND CHOKE

Item	Description	Quantity	Part Number
1	THROTTLE CABLE	1	TQU-16305
2	CHOKE CABLE	1	TQA-16205
3	HAND THROTTLE CASE	1	ZMS-008
4	HAND THROTTLE LEVER	1	ZMS-013
5	HAND THROTTLE LEVER PIVOT	1	ZMS-014
7	CHOKE LEVER	1	TQA-16210
10	CABLE TIE	8	HTW-002
11	WASHER	2	FWM5-B
12	WASHER	3	FW3-12
13	EXTERNAL CIRCLIP	1	FX-003
14	NYLON WASHER	1	FWP-001
15	WASHER	1	FW4-T3
16	CURVED SPRING WASHER	1	FWM10-001
18	NYLOCK NUT	1	FNM5-NT
19	NYLOCK NUT	1	FNM5-NP
20	NYLOCK NUT	1	FNM6-NT
21	SCREW (PVC, PATCH)	1	FMSU-001
22	SOCKET CAP SCREW	2	FCM5-16
23	PAN HEAD SET SCREW	1	FMS6-20
25	RAISED SKIFFY CAP	2	PMC-RSC10
26	SKIFFY - RING	2	PMC-SB10
27	TAPE (50 x 20mm)		DT116-001

ELECTRICAL AND INSTRUMENTS

SHEET 1 of 2 - INSTRUMENT FIT

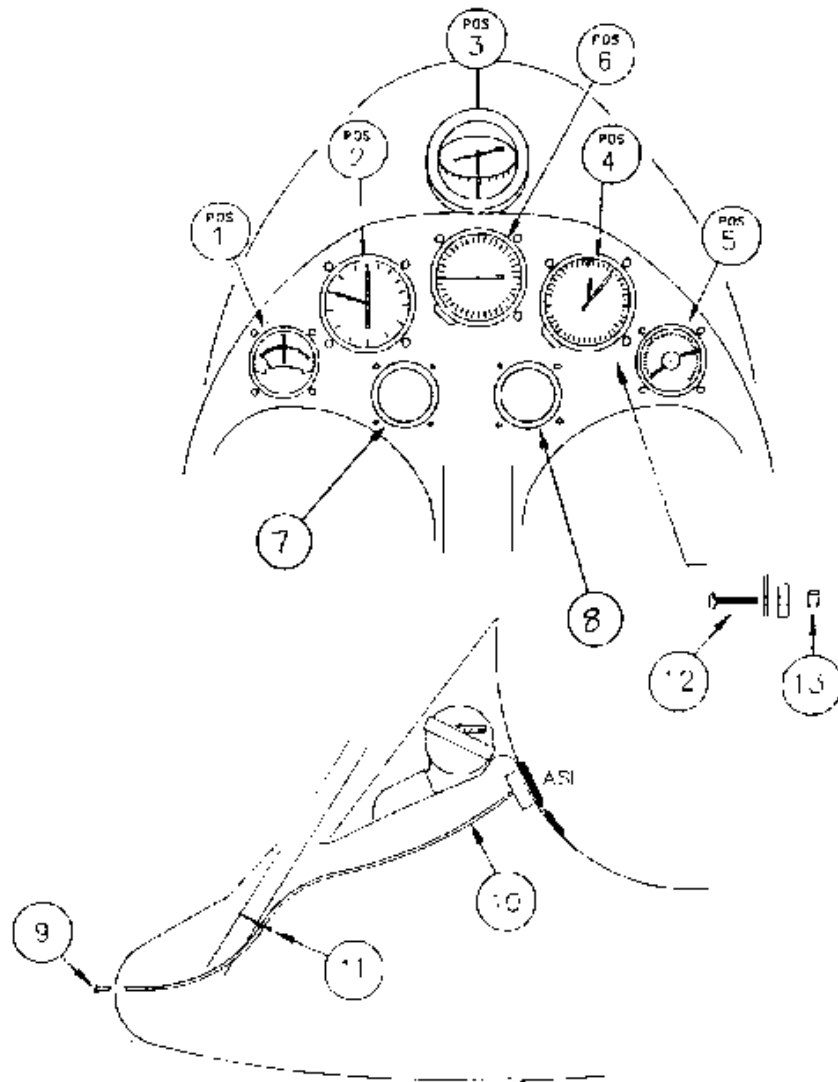

ELECTRICAL AND INSTRUMENTS

SHEET 2 of 2 - LOOM FITTING

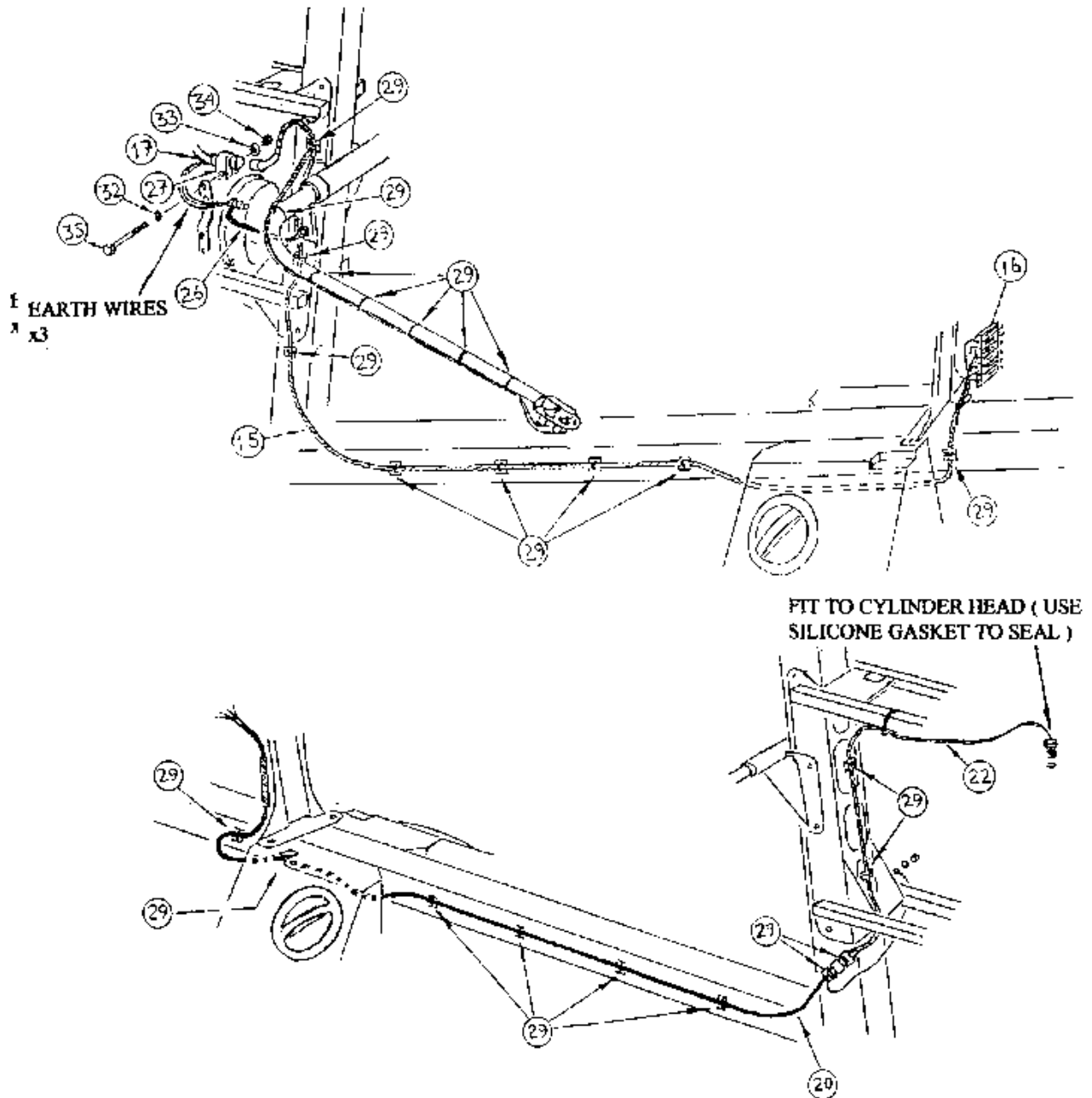

ELECTRICAL AND INSTRUMENTS

Item	Description	Qty	Part Number
1	WATER TEMPERATURE GAUGE	1	IEWT-2
2	ASI 0 - 1 OOMPH	1	IFASI-5
3	SILVA COMPASS	1	IFCOM-1
4	ALTIMETER -MICROFLIGHT1	1	IFALT-4
5	AVIASPORT RPM METER	1	IERP-6
6	VS1 +1 - 2000	1	IFVSI-3
7	HOURMETER (VDO)	1	IEHM-2
8	WESTACH EXHAUST GAS TEMP.	1	IEEGT-2
9	PITOT	1	ZMP-036
10	PITOT PIPE	1	
11	CABLE TIE	1	HTW-002
12	PAN HEAD BRASS SCREW	10	FSM4-20
13	BRASS BINX NUT	10	FNM4-11X
15	POWER LOOM	1	TQU-16534
16	FUSE RACK		LJ-002
17	ENGINE POWER WIRING CONNECTOR ASSEMBLY		
20	SIGNAL WIRE - MAIN CABLE	1	TQA-16550
22	WATER TEMPERATURE GAUGE SENDER CABLE	1	TQA-16580
26	EARTH STRAP		
27	CABLE CLEAT	1	HCC-004
28	HOT MELT TAPE (2 x 0.12m)		DHMT-001
29	CABLE TIE	25	HTW-002
32	WASHER	1	FWM5-11
33	WASHER	3	FW3-12
34	NYLOCK NUT	1	FNM5-NT
35	HEX BOLT	1	FBM5-35

• ITEM 21
 CREATE TWO HOSES FROM RH1682
 (USE ONLY HOSE 'A' ON RADIATOR LOWER)

CUT OFF AND
 REMOVE THIS END

CUT IN MIDDLE OF
 STRAIGHT SECTION

FIT IMMEDIATELY ABOVE RIB
 AND BELOW HEAD VENT PIPE
 ON TANK

CUT OFF 15mm

WIRELOCK AROUND OIL FILLER
 AND BETWEEN LEVEL PLUGS

ALL HEAD NUTS TO BE RE-SEALED WITH SILICONE
 SEALANT AND RETORQUED AS PER ENGINE MANUAL
 IF REMOVED TO FIT BRACKETS

SHORTEN OIL TUBE (IDENTIFIED)
 TO CLEAR WASHER (ITEM 39) ON
 LORD MOUNT.

ITEM 10 SHOULD BE REVERSED WHEN
 FITTING 'CYCLONE' TYPE ELECTRIC
 CARBURETTOR HEATERS

FIT TO ITEM 10

SLIDE ON RADIATOR SPIGOT

RADIATOR ARM

FIT TO ARM

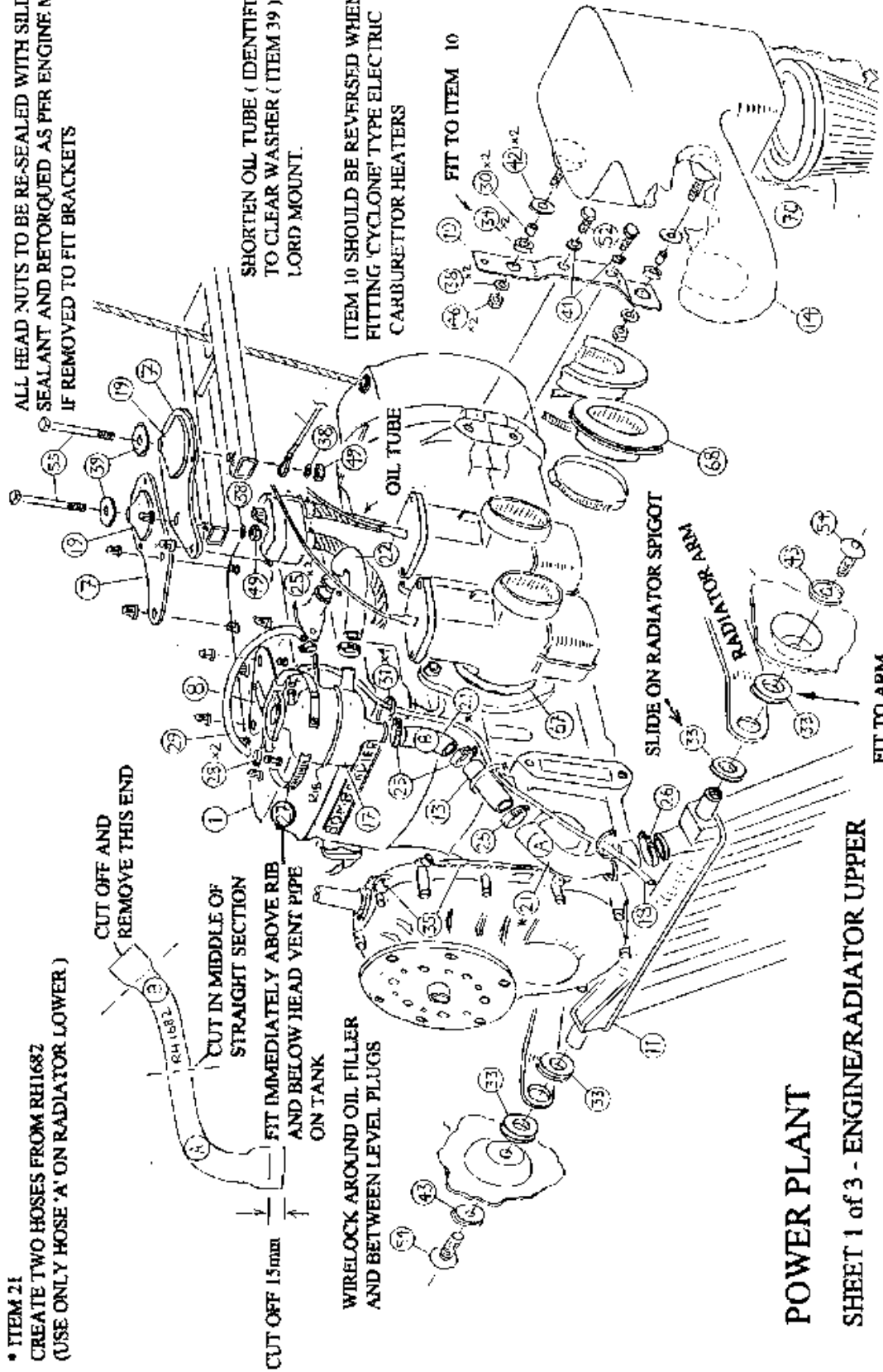

POWER PLANT

SHEET 1 of 3 - ENGINE/RADIATOR UPPER

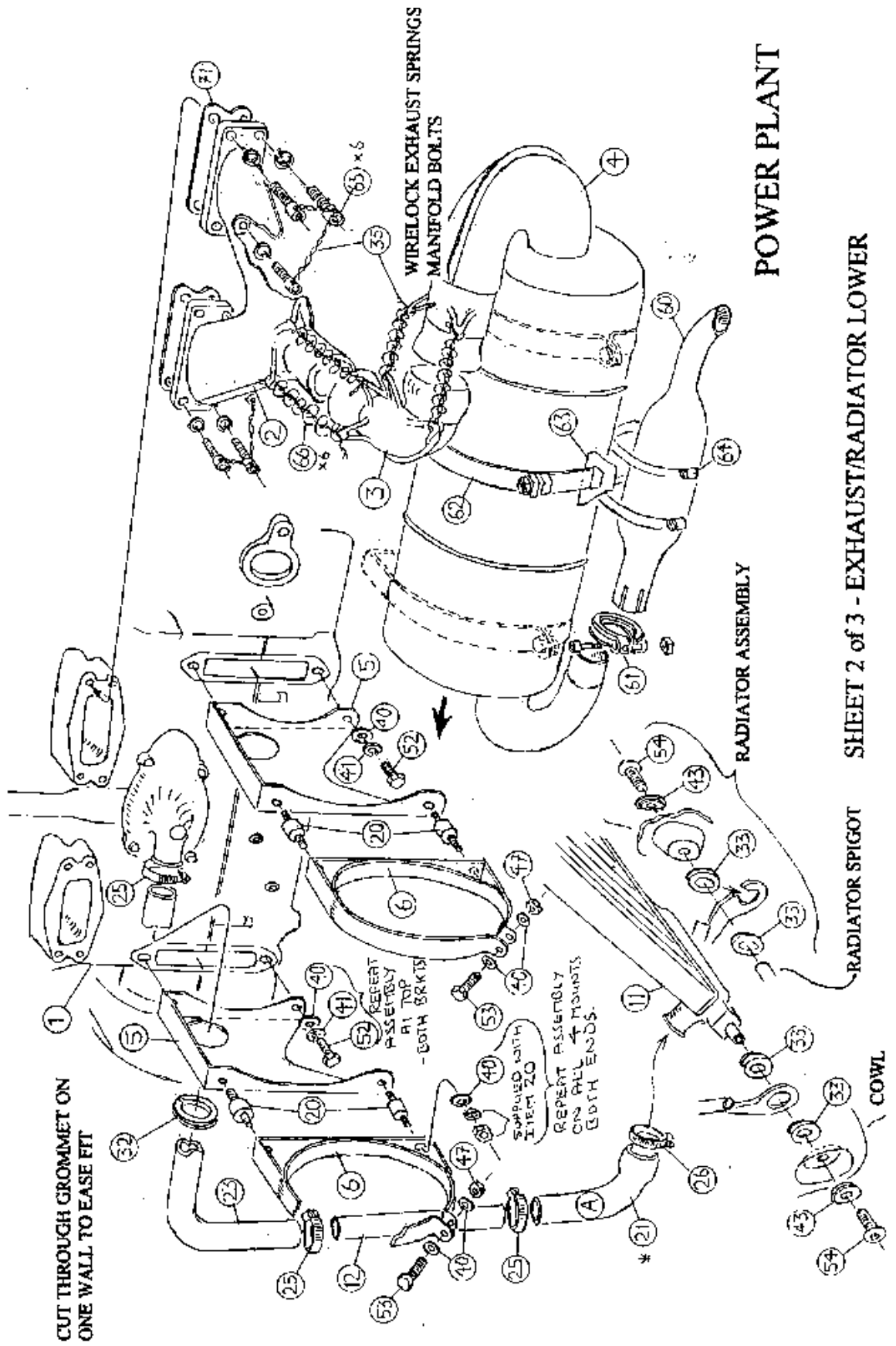

POWER PLANT

ENGINE PLATES TO ENGINE BRACKET

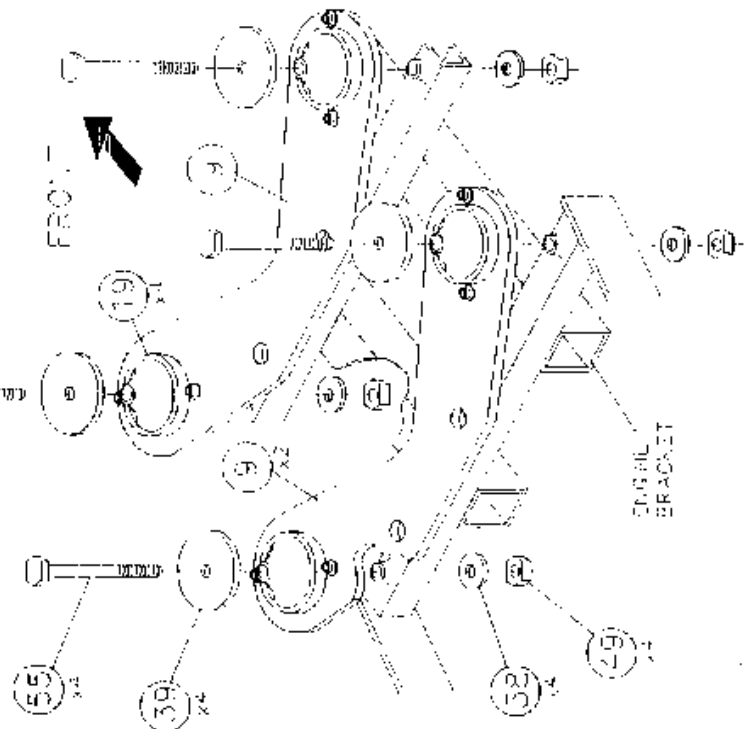

FRONT

ENGINE PLATES TO ENGINE
 MOUNTS TO PLATES

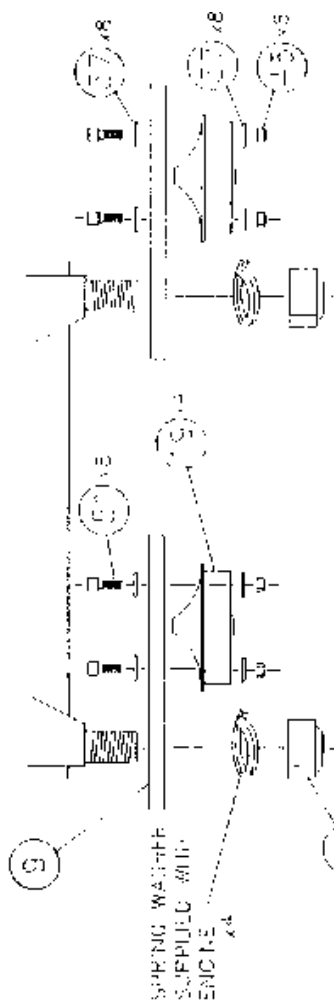

LOOSE MOUNTS (ITEM 19) SHOULD BE
 FASTENED TO HEAD MOUNTING PLATES
 (ITEM 7) WITH THE SAME FASTENERS AND
 IN THE SAME ORIENTATION AS THE ABOVE
 ASSEMBLY

SHEET 3 of 3 - ANTI VIBRATION MOUNTS AND ENGINE PLATE

POWER PLANT

Item	Description	Qty	Part Number
1	ENGINE 582 L/C - MODIFIED	1	TQA-15158
2	EXHAUST MANIFOLD	1	TQA-15212
3	EXHAUST MANIFOLD ELBOW	1	TQA-15214
4	EXHAUST MAIN MUFFLER	1	TQA-15210
5	EXHAUST BRACKET	2	TQA-15220
6	EXHAUST STRAP	2	TQA-15270
7	BEAD MOUNTING PLATE	2	TQA-15320
8	HEADER TANK BRACKET	1	ZMS-158
9	ENGINE PLATE	2	ZPL-019
10	MUFFLER MOUNTING BRACKET	1	ZMS-162
11	MODIFIED RADIATOR	1	TQA-15185
12	LEFT HAND HOSE CONNECTOR	1	ZMA-054
13	RIGHT HAND HOSE CONNECTOR	1	ZMA-055
14	INTAKE MUFFLER	1	TQA-18305
17	HEADER TAP.1K	1	ELT-001
18	CLEAR PVC TUBE (0.47m)		PT13-001
19	LORD MOUNT	6	EVI-001
20	TWO BOLT MOUNTING	4	EVI-005
21	HOS-E	2	ELH-002
22	HOSE	1	ELH-003
23	HOSE	1	ES-922381
25	J1 TRILEE TYPE CLIP	8	HCJ-004
26	JUBILEE TYPE CLIP	2	HCJ-002
27	JUBILEE TYPE CLIP	1	HCJ-003
28	HOSE CLIP	2	HCM10-001
29	CYLINDER HEAD VENT HOSE (300mm)	1	ES-860300
30	BUSH	2	ZSP-013
31	CABLE TIE	4	HTW-002
32	THERMO RUBBER GROMMET	1	PMM-018
33	RUBBER GROMMET	8	PMM-008
34	RUBBER GROMMET	2	PMM-014
35	10m REAL OF SEIZING WIRE		RW-SW
37	WASHER	24	FWM5-B
38	WASHER	8	FW4-T3
39	WASHER	6	FW4-18
40	WASHER	16	FWM8-B
41	SPRING WASHER	6	FWM8-SW
42	NYLON WASHER	2	FWP-001
43	SKIFFY - RING ONLY	4	PMC-SB8
45	NYLOCK NUT	12	FNM5-NT
46	NYLOCK NUT	2	FNM6-NT
47	NYLOCK NUT	2	FNM8~NP

48	NYLOCK NUT	4	FNMI0-NT
49	NYLOCK NUT	6	FNU4-NP
51	SCREW	12	FCM5-16
52	SCREW	6	FSM8-16
53	HEX BOLT	2	FBM8-30
54	SCREW	4	FMS8-15
55	HEX BOLT	6	FBU4-26
60	AFTER MUFFLER	1	ES-878967
61	CLAMP	1	ES-953251
62	STRAP	1	ES-851140
63	MOUNTING BRACKET	1	ES-851150
64	JUBILEE TYPE CLIP	2	ES-851130
65	EXHAUST ALLEN BOLT	6	ES-840991
66	EXHAUST SPRING	6	ES-938790
67	CARBURETTOR TO ENGINE RUBBER	2	ES-267785
68	CARBURETTOR TO INTAKE MUFFLER RUBBER	2	ES-825660
69	SPARK PLUG	4	ES-897050
70	AIR FILTER + RETAINING RING	1	ES-825510/20
71	EXHAUST GASKET	2	ES-850630

FAIRINGS

SHEET 3 of 3 - ENGINE COWL / WHEEL SPATS

