



Q2 WING

Parts Catalogue



Cyclone Airsports Ltd trading as Pegasus Aviation
Elm Tree Park, Manton, Marlborough, Wiltshire. UK
Telephone +44 (0) 1672 861578 Fax +44 (0) 1672 861550
www.pegasusaviation.co.uk email - parts@pegasusaviation.co.uk

CONTENTS

ASSEMBLY	Page
Leading edge	1
Cross Spar	3
Control Frame	5
Fin Tube	8
Keel Tube	10
Final Assembly	13

LEADING EDGE

LEFT LEADING EDGE SHOWN
RIGHT SIDE IS A MIRROR OF LEFT

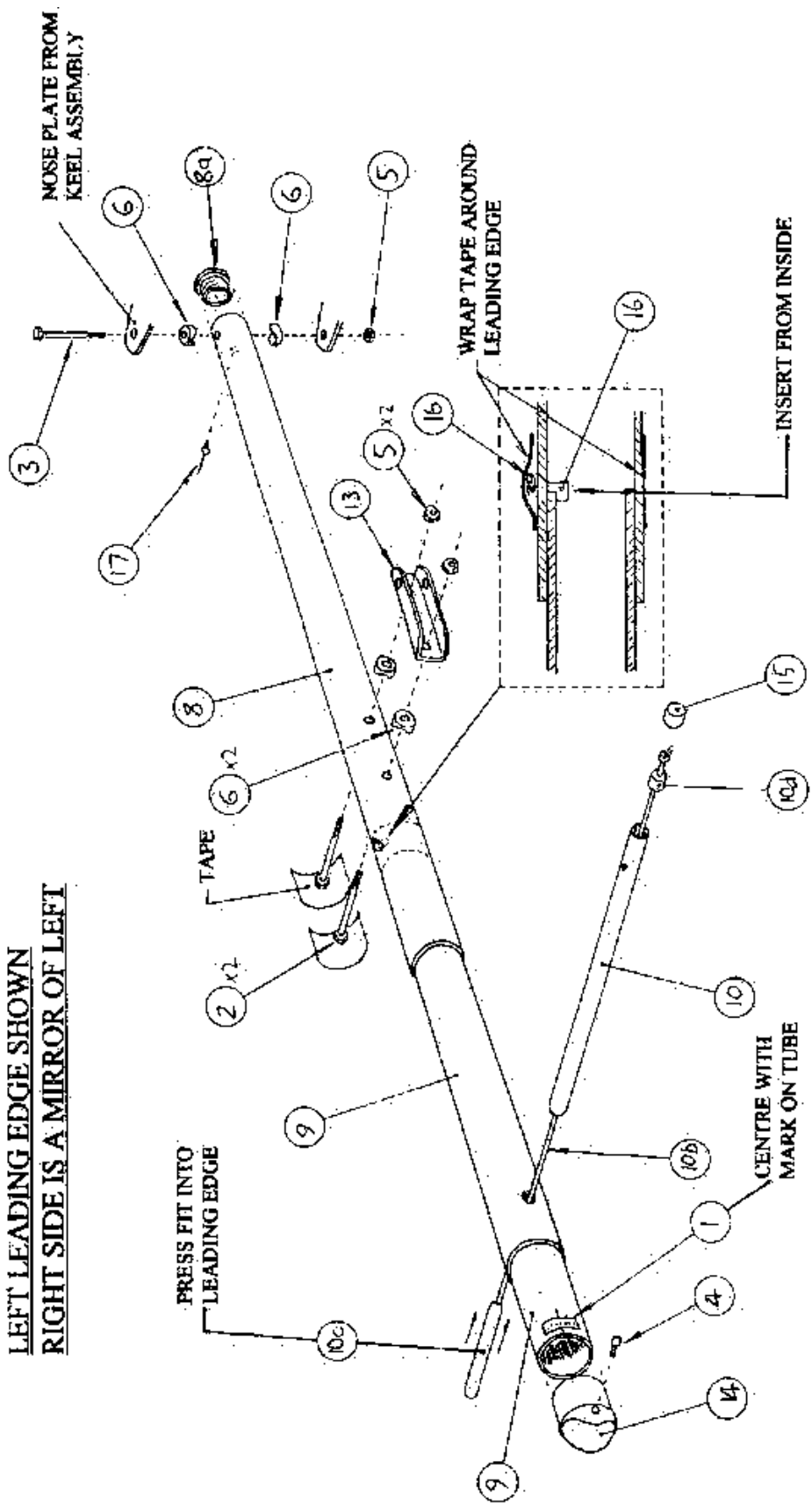

LEADING EDGE

1	TIP ADJUST PLACARD	2	DP-030
2	HEX BOLT	4	FBU4-30
3	HEX BOLT	2	FBU4-32
4	SOCKET CAP SCREW	2	FCM6-20
5	NYLOCK NUT	6	FNU4-NP
6	PLASTIC SADDLE	8	PMS-M8-21L
8	LEADING EDGE FRONT SECTION (LEFT)	1	YQB-31101
8a	BLACK END PLUG	2	PEP16-001
9	LEADM EDGE REAR SECTION (LEFT)	1	YQB-31102
10	WASHOUT TUBE	2	YQB-31103
10b	SHOCK CORD		VSC5-001
10c	WASHOUT ROD INSERT PLUG	2	ZIN-010
10d	WASHOUT ROD COLLET	2	ZSP-041
11	LEADING EDGE FRONT SECTION (RIGHT)	1	YQB-31201
12	LEADING EDGE REAR SECTION (RIGHT)	1	YQB-312 02
13	LEADING EDGE CHANNEL	2	ZCH-010
14	TURN TIP PLUG	2	ZMP-055
15	BLACK END CAP	2	PECS-001
16		2	FPCP-001
17	POP RIVET	2	FR4-16-001

CROSS SPAR

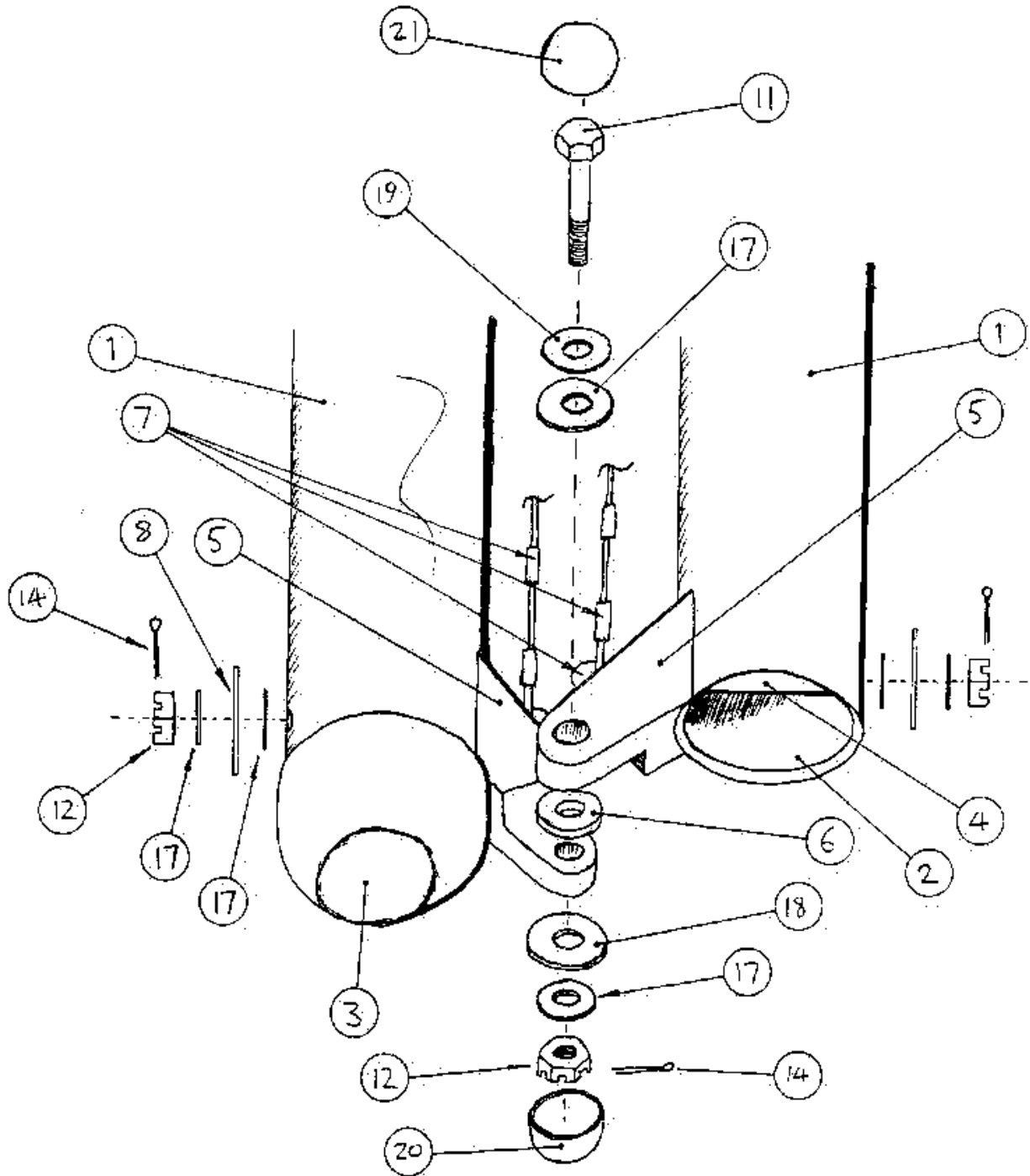

ITEM 12 FINGER RIGHT ONLY

CROSSPAR

1	CROSSPAR	2	YQB-31622
2	CROSS SPAR BALL SEAT	1	ZIN-009
3	CROSS SPAR CENTRE BALL	1	ZMP-010
4	BALL SEAT BUSH (PART OF ITEM 2	1	
5	PIVOT BLOCK	2	ZMA-002
6	PIVOT BLOCK SPACER	1	ZSP-008
7	RESTRAINT CABLE	1	YQB-31640
8	ANTI FLOAT WEBBING	1	YQB-31660
11	HEX BOLT	1	FBA5-15
12	CASTLE NUT	3	FNU5-CN
14	SPLIT PIN	3	FPSP-002
17	WASHER	6	FW5-T3
18	SKIFFY WASHER	1	PMC-SB10
19	SKIFFY WASHER	1	PMC-SB8
20	SKIFFY CAP	1	PMC-RSCIO
21	SKUFFY CAP	1	PMC-SC8

CONTROL FRAME

SHEET 1 of 2

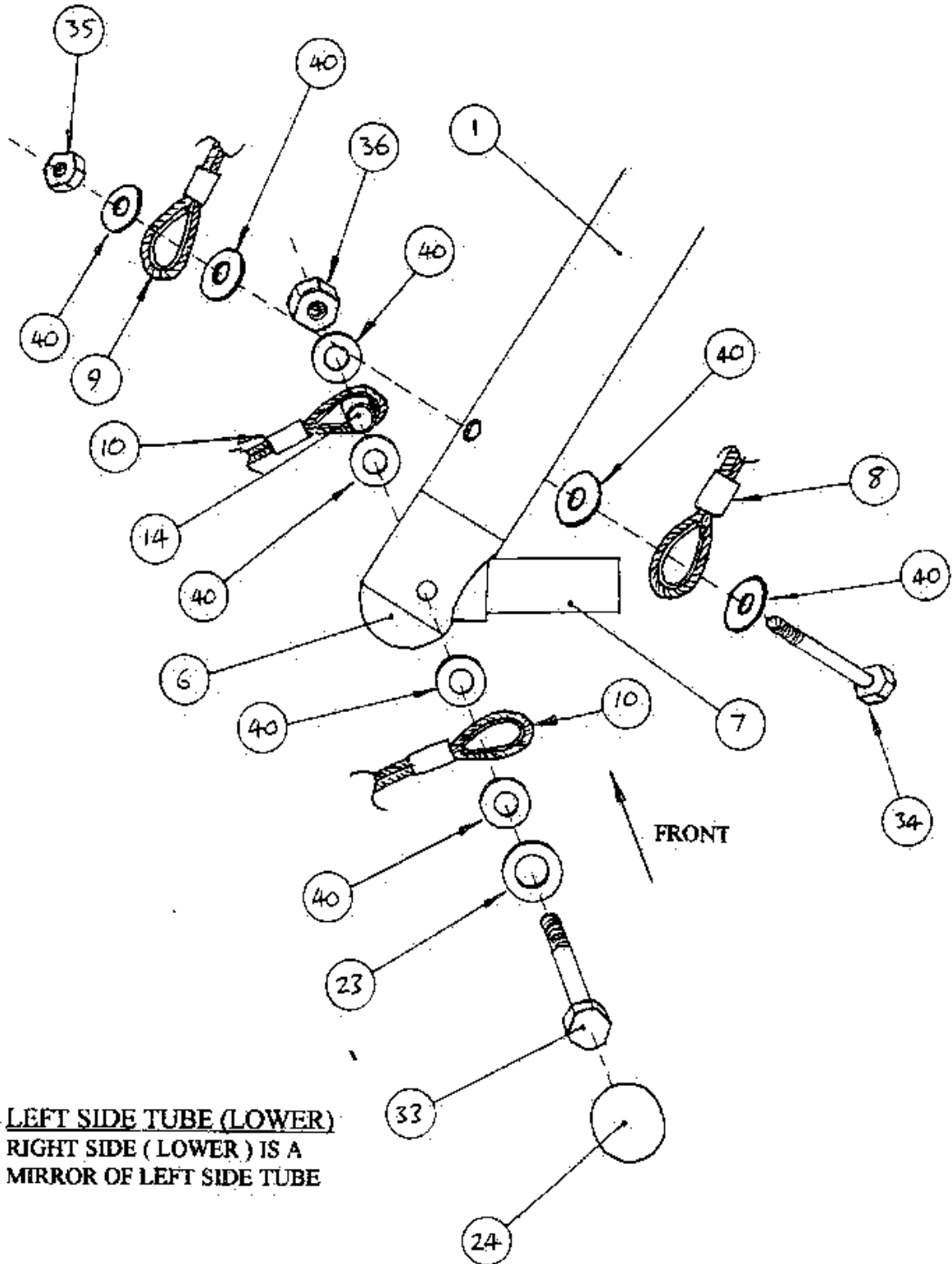

LEFT SIDE TUBE (LOWER)
RIGHT SIDE (LOWER) IS A
MIRROR OF LEFT SIDE TUBE

CONTROL FRAME

SHEET 2 of 2

TRIMMER WHEEL ASSEMBLY (RIGHT SIDE)

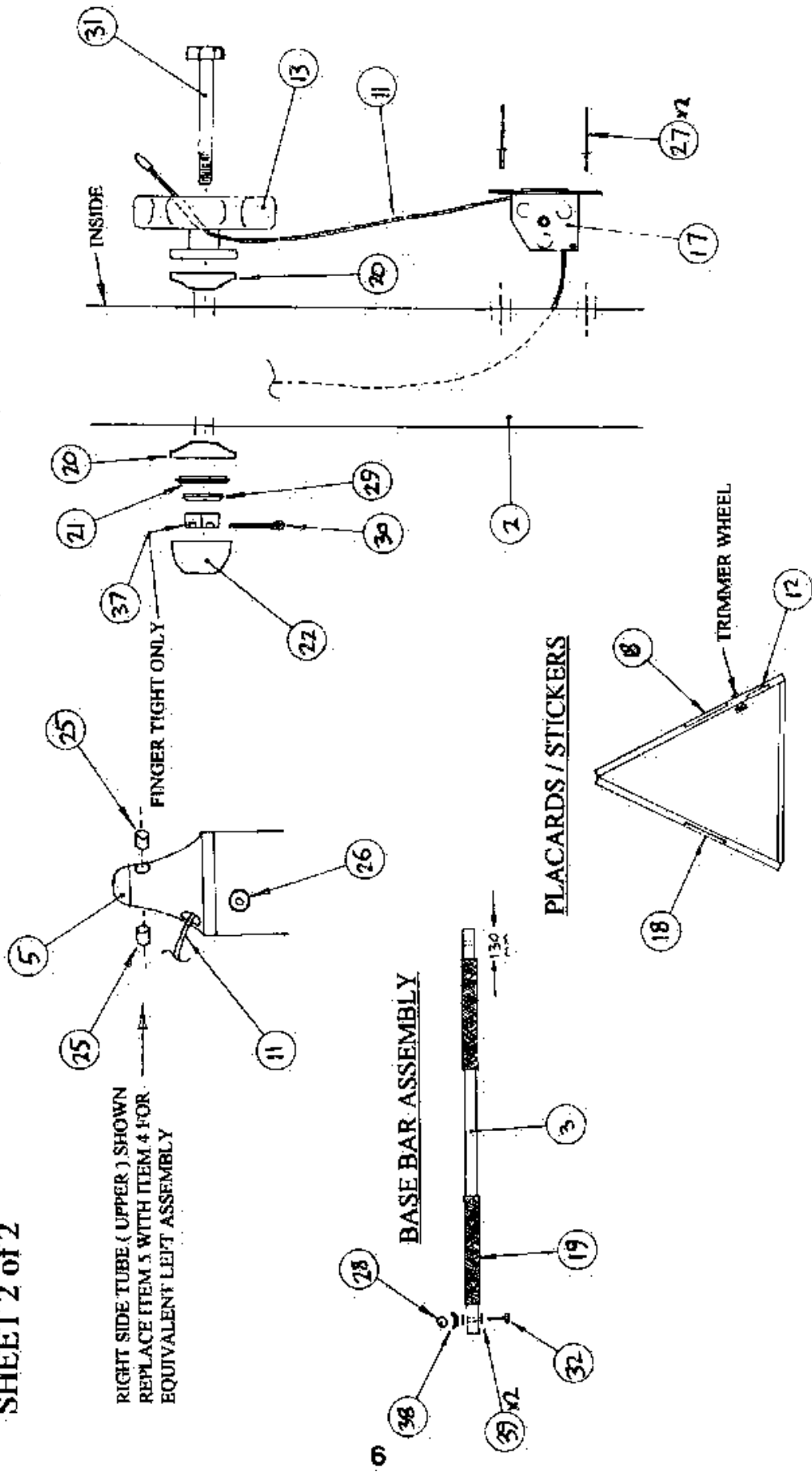

CONTROL FRAME

1	CONTROL FRAME SIDE (LEFT)	1	YQB -51000
2	CONTROL R~ SIDE (RIGHT)	1	YQB-5 1100
3	CONTROL FRAME BASE TUBE	1	YQB-51200
4	CONTROL FRAME UPPER KNUCKLE (LEFT)	1	ZKN- 119
5	CONTROL R~ UPPER KNUCKLE (RIGHT)	1	ZKN-120
6	CONTROL FRAME SIDE LOWER KNUCKLE	2	ZKN-101
7	CONTROL FRANIE BASE TUBE KNUCKLE	2	ZKN-102
8	LOWER FRONT RIGGING	1	YQB-61300
9	LOWER REAR RIGGING	1	YQB-61000
10	LOWER RIGGING SIDE CABLE	4	YQB-61100
11	TRIM CABLE ASSEMBLY	1	YQB-51310
12	PITCH TRIM PLACARD	1	DP-029
13	TRMWER WIIEL	1	ZMP-056
14	BASE SIDE WIRE SPACER	2	ZSP-043
17	MAST SHEAVE	1	RP-3
18	LARGE PEGASUS 2 COLOUR STICKER	2	DVL-004
19	BASE BAR HAND GRIPS	2	PMM-009
20	PLASTIC SADDLE	2	PMS-M8-17
21	1 SKIFFY - RING ONLY	1	PMC-SBIO
22	RAISED SKIFFY CAP	1	PMC-RSC10
23	SKIFFY - RING ONLY	2	PMC-SB8
24	SKIFFY - CAP ONLY	2	PMC-SC8
25	BEARING	4	BEA-BB-4
26	AVDEL	2	FR6-12-002
27	POP RIVET	2	FR4-16-001
28	SAFETY RING	2	FPSR-001
29	EYELET SPACER	1	ZSP-006
30	SPLIT PIN	1	FPSP-002
31	HEX BOLT	1	FBM6-85
32	HEX BOLT	2	FBA4-15
33	HEX BOLT	2	FBAS-27A
34	HEX BOLT	2	FBA4-25A
35	NYLOCK NUT	2	FNU4-NP
36	NYLOCK NUT	2	FNU5-NP
37	CASTLE NUT	1	FNM6-CN
38	WING NUT	2	FNU4-WN
39	WASHER	4	FW4-T4
40	WASHER	16	FW5-T4

FIN TUBE

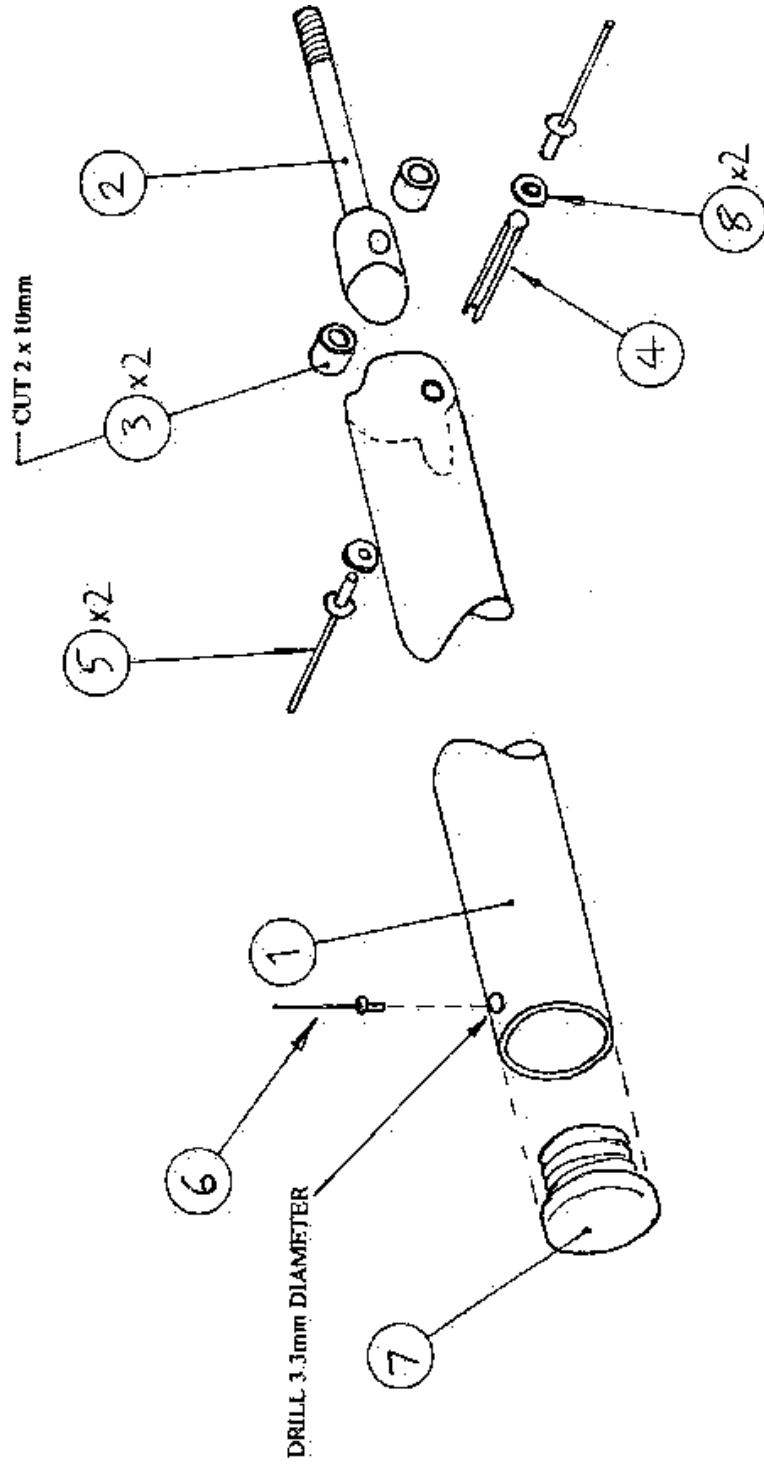

FIN TUBE

1	FIN TUBE	1	YQB-31710
2	DOME BOLT	1	FDM6-40
3	CLEAR PVC TUBE	2	PTI6-003
4	ROLL PIN	1	FPRP-001
5	MONEL	2	FR5-12-001
6	POP RIVET	1	FR4-16-001
7	BLACK END PLUG	1	PEP8-001
	MILD STEEL WASHER	2	FW3-T3

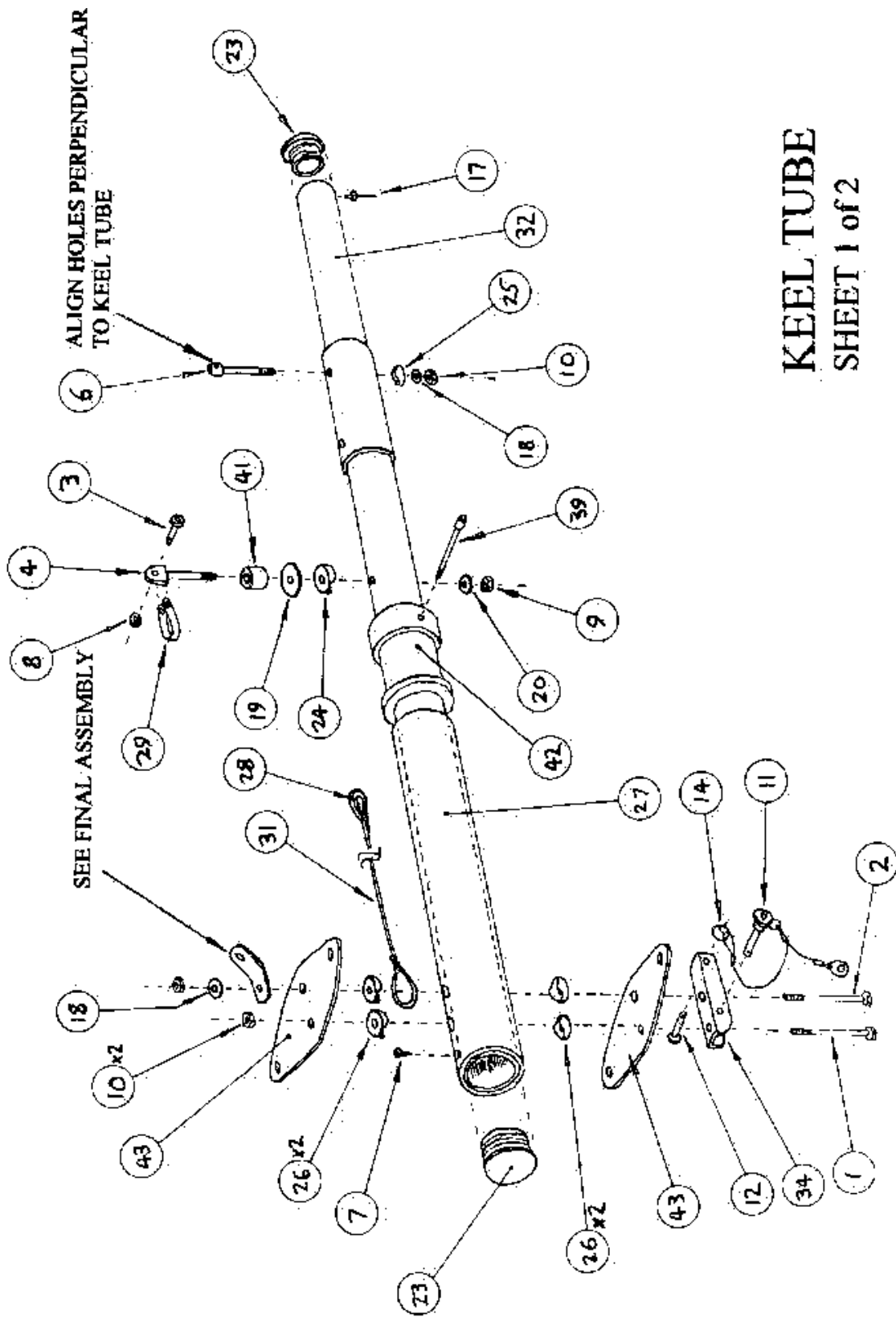

KEEL TUBE
SHEET 1 of 2

KEEL TUBE SHEET 2 of 2

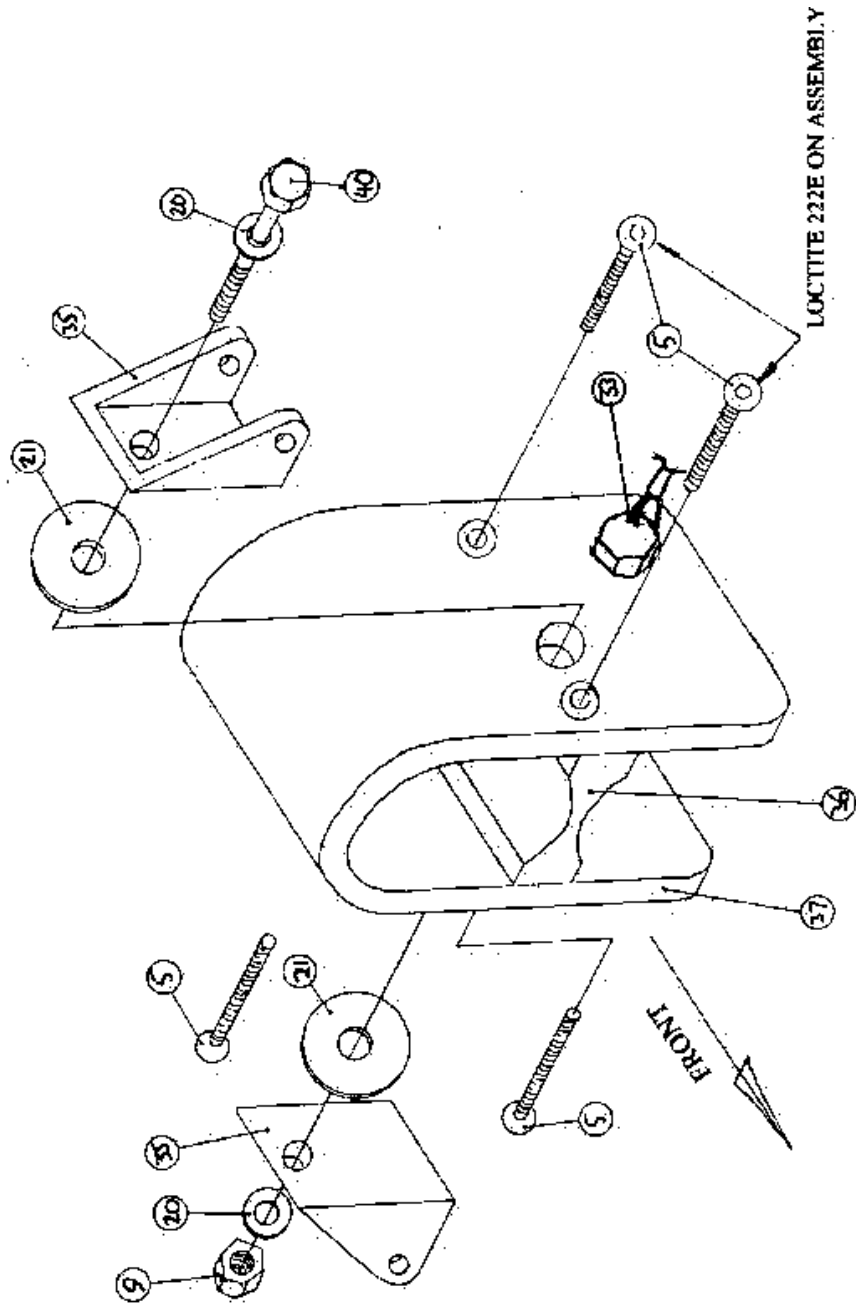

KEEL TUBE

1	HEX BOLT	1	FBU4-32
2	HEX BOLT	1	FBU4-34
3	SOCKET CAP SCREW	1	FCM5-16
4	EYE BOLT	1	FEM8-65
5	SCREW	4	FMS6-35
6	RESTRAINT STUD	1	FMSS-1
7	SCREW	1	FMSST-004
8	NYLOCK NUT	1	FNM4-NT
9	NYLOCK NUT	2	FNM8-NT
10	NYLOCK NUT	3	FNU4-NP
11	PUSH PINS	1	FP-001
12		1	FPCP-001
14	SAFETY RING	1	FPSR-001
17	POP RIVET	1	FR4-16-001
18	WASHER	2	FW4-T4
19	WASHER	1	FW5-14
20	WASHER	3	FW5-T3
21	NYLON WASHER	2	FWP-002
23	BLACK END PLUG	2	PEP16-001
24	PLASTIC SADDLE	1	PMS-M8-21L
25	PLASTIC SADDLE	1	PMS-M8-21S
26	PLASTIC SADDLE	4	PMS-M8-22
27	KEEL PROTECTING SLEEVE	1.33m	PTI32-002
28	STAINLESS STEEL THMLE	1	RE3-SS
29	STRIP SHACKLE	1	RS-3
31	SHOCK CORD	1.5m	VSC4-001
32	KEEL TUBE	1	YQB-31301
33	HANG BOLT + LANYARD	1	YQB-31302
34	NOSE/SCATCH CHANNEL	1	ZCH-006
35	CONIROL FRAME CHANNEL	2	ZCH-017
36	ROLL BRACKET SPACER BLOCK	1	ZMA-023
37	ROLLBRACKET	1	ZMA-041
39	BOLT	1	ZMF-003
40	CHANNELBOLT	1	ZMF-010
41	KING POST BASE LOCATOR	1	ZMP-003
42	ROLL BRACKET BEARING	1	ZMP-014
43	NOSE PLATE	2	ZPL-003

12FINAL ASSEMBLY

1	UPPER SME RIGGING	1	YQB-62100
2	UPPER RIGGING FRONTIRP IEPA RR	1	YQB-62200
3	KING POST CROWN	1	ZMP-004
4	CABLE RETENTION TUBE	1	YQB-41010
5	KING POST	1	YQB-41000
6	INNER REFLEX RETENTION CABLE	1	YQB-62300
7	NWDLE REFLEX RETENTION CABLE	1	YQB-62400
8	OUTER REFLEX RETENTION CABLE	1	YQB-62500
9	TRIM BRIDLE (INNER LUFF)	1	YQB-51320
10	TRIM BRIDLE (MIDDLE-LUFF)	1	YQB-51325
11	UPPER RIB 1 (RIGHT)	1	YOB-71100
12	UPPER RIB 2 (RIGHT)	1	YQB-71105
13	UPPER RIB 3 (RIGHT)	1	YQB-71110
14	UPPER RIB 4 (RIGHT)	1	YQB-71115
15	P RIB 5 (RIGHT)	1	YQP-71120
16	UPPER RIB 6 (RIGHT)	1	YQB-71125
17	UPPER RIB 7 (RIGHT)	1	YQB-71130
18	UPPER RIB 8 (RIGHT)	1	YQB-71135
19	UPPER RIB 9 (RIGHT)	1	YQB-71140
20	UPPER RIB 10 (RIGHT)	1	YQB-71145
21	UPPER RIB 11 (RIGHT)	1	YQB-71150
22	UPPER RIB 1 (LM)	1	YQB-71200
23	UPPER RIB 2 (LUT)	1	YQB-71205
24	UPPER RIB 3 (LM)	1	YQB-71210
25	UPPER RIB 4 (LM)	1	YQB-71215
26	UPPER RIB 5 (LEFT)	1	YQB-71220
27	UPPER RIB 6 (LEFT)	1	YQB-71225
28	UPPER RIB 7 (LEFT)	1	YQB-71230
29	UPPER RIB 8 (LEFT)	1	YQB-71235
30	UPPER RIB 9 (LEFT)	1	YQB-71240
31	UPPER RIB 10 (LM)	1	YQB-71245
32	UPPER RIB 11 (LEM)	1	YOB-71250
33	NOSE RIB	1	YQB-71300
34	LOWER RIB 1 (RIGHT)	1	YQB-72100
35	LOWER RIB 2 (RIGHT)	1	YQB-72110
36	LOWER RIB 3 (RIGHT)	1	YQB-72120
37	LOWER RIB 1 (LEFT)	1	YQB-72200
38	LOWER RIB 2 (LEFT)	1	YQB-72210
39	LOWER RIB 3 (LEFT)	1	YQB-72220
42	SW TAP SCREW	4	FMSST-002
43	BLACK END CAP	1	PECIO-001
44	POP RIVET	2	FR4-16-001
45	TRIPPLE PULLEY BLOCK	1	RP-17
46	STRIP SHACKLE	6	RS -4

FINAL ASSEMBLY continued

47	UNF HEX BOLT	2	FBU4-30
48	PLASTIC SADDLE	4	PMS-MS-21S
49	WASHER	7	FW4-T4
50	TANG	1	RT-2H-HD3
51	NYLOCKNUT	2	FNU4-NP
52	SAFETY PIN	1	FP~003
53	CORD (2450mm)		VPRS-001
54	SKIFFY _ CAP ONLY	4	PMC-SC8
55	HEX BOLT	2	FBM8-50
56	SKIFFY - RING ONLY	4	PMC-SB8
57	NYLOCKNUT	2	FNM8-NT
58	HEX BOLT	2	FBM5-3559
59	DECK EYE.SHACLE	2	RM-1
60	NYLOCKNUT	2	FNM5-NT
61	NYLOCKNUT	2	FNM6-NT
62	HEX BOLT	2	FBA5-24
63	I-FADING EDGE CHANNEL SPACER	2	ZSP-001
64	PLASTIC SADDLE	2	PMS-5-25
65	HALF ROUND SPACER	2	ZSP-026
66	NYLON WASHER	2	FWP-002
67	WASHER	2	FW5-10
68	SPLIT PIN	4	FPSP-002
69	CASTLE WN	2	FNU5-CN
70	RAISED SKIFFY CAP	4	PMC-RSC10
71	HEX BOLT	2	FBA6-41
72	WASHER	6	FWMIO-B
73	SWFY - RTNG OWLY	4	PMC-SB10
74	CASTLE NUT	2	FNU6-CN

FINAL ASSEMBLY

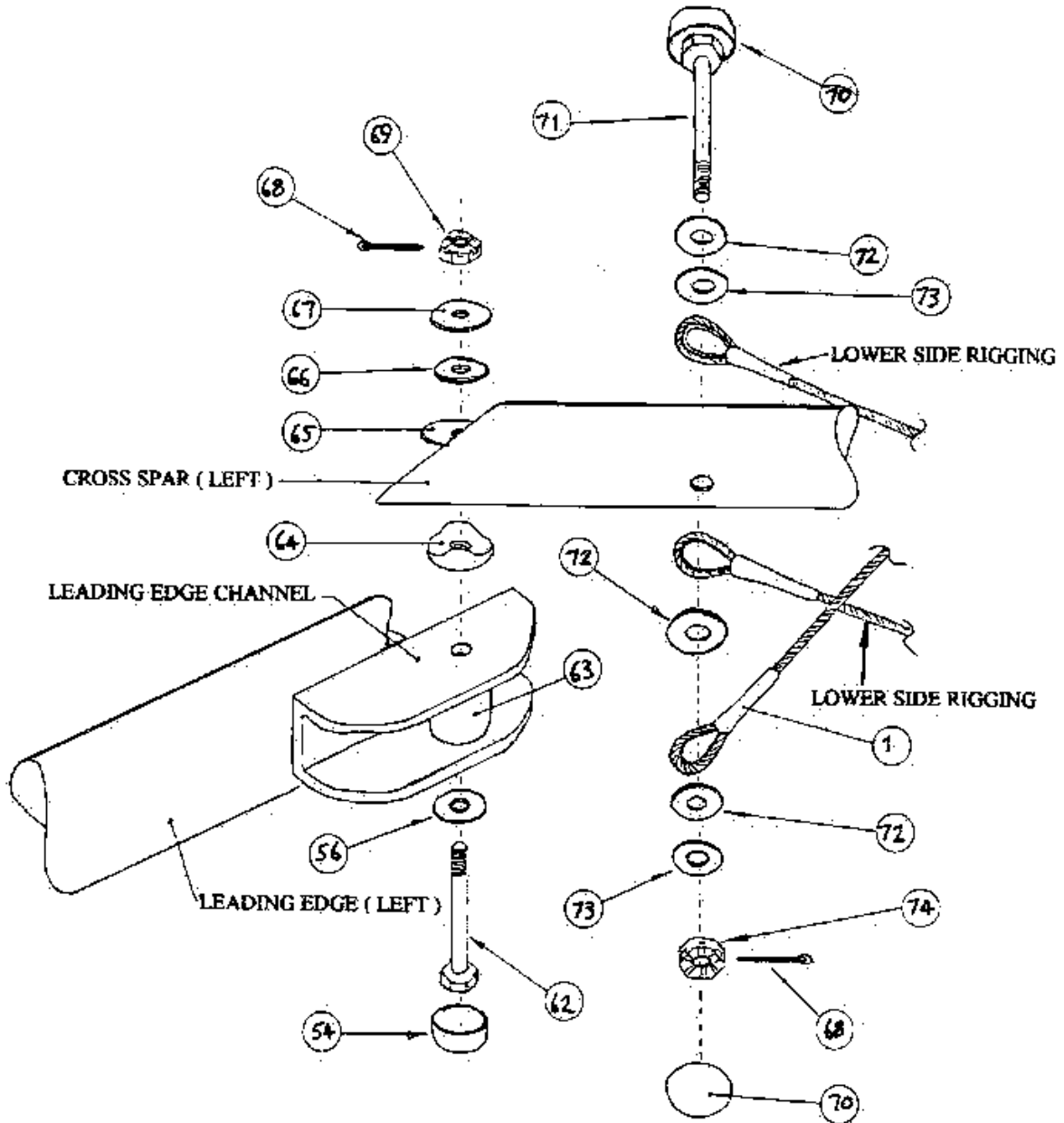

SHEET 1 of 5
 CROSS SPAR TO LEADING EDGE
 RIGGING TO CROSS SPAR

FINAL ASSEMBLY

SHEET 2 of 5

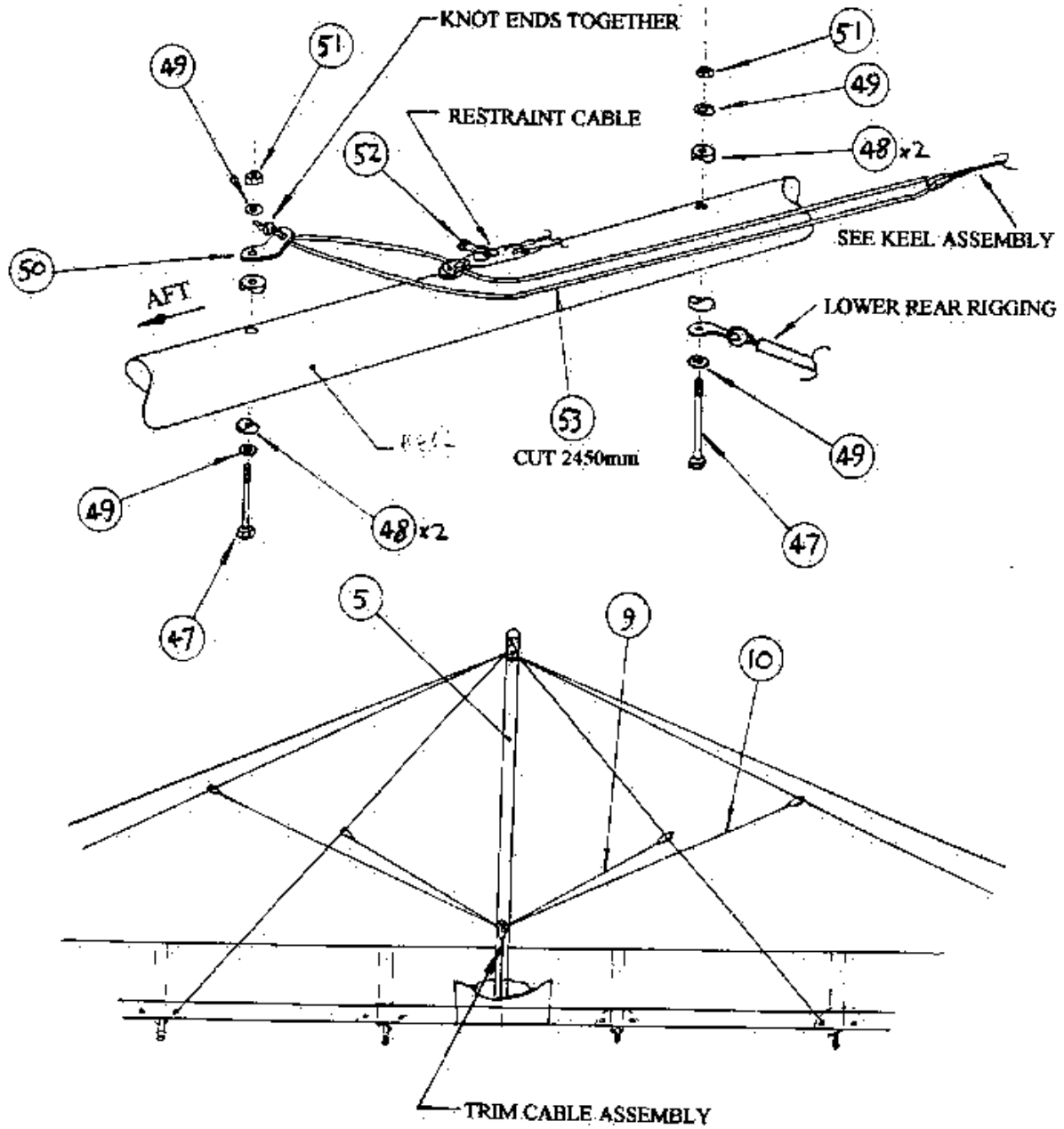

FRONT ELEVATION

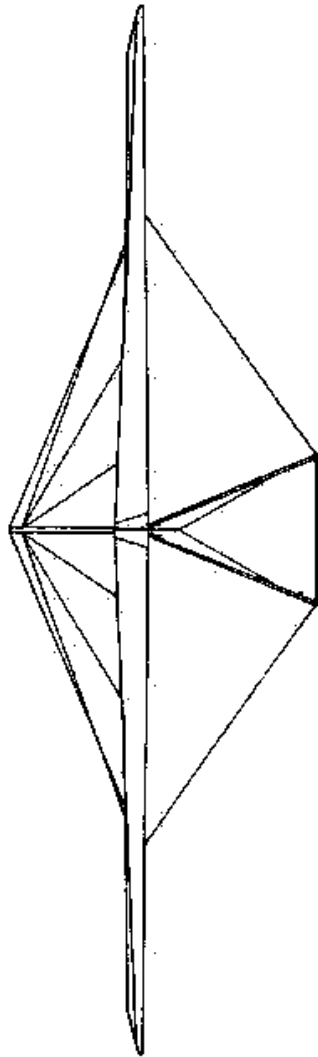

SIDE ELEVATION

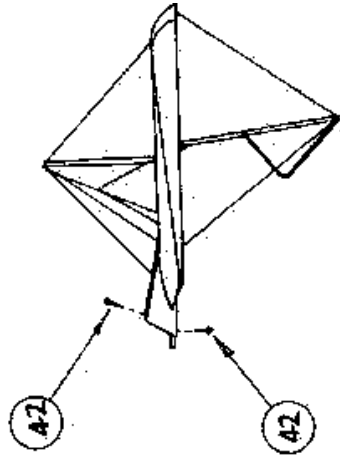

UNDERSIDE ELEVATION

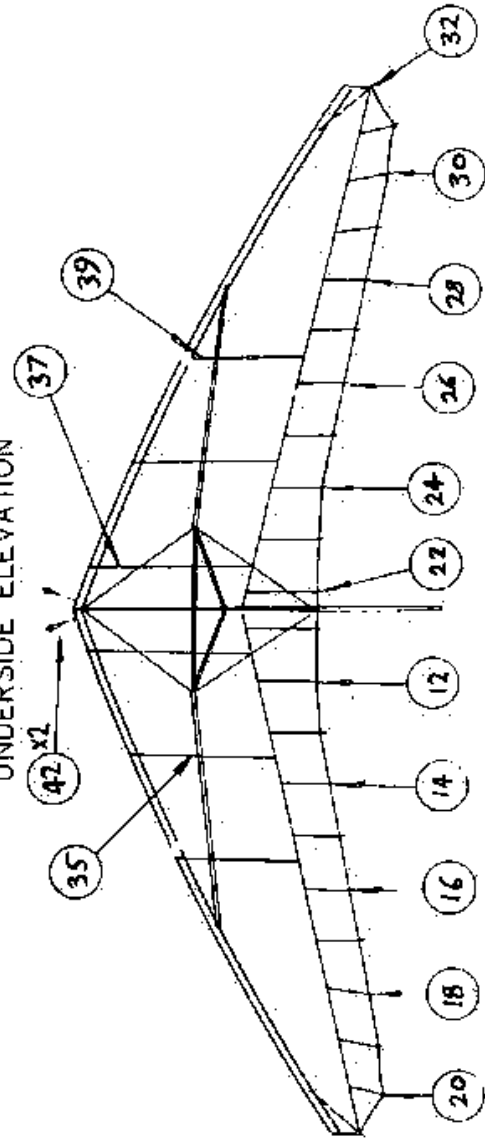

FINAL ASSEMBLY
SHEET 3 of 5

FINAL ASSEMBLY

SHEET 4 of 5

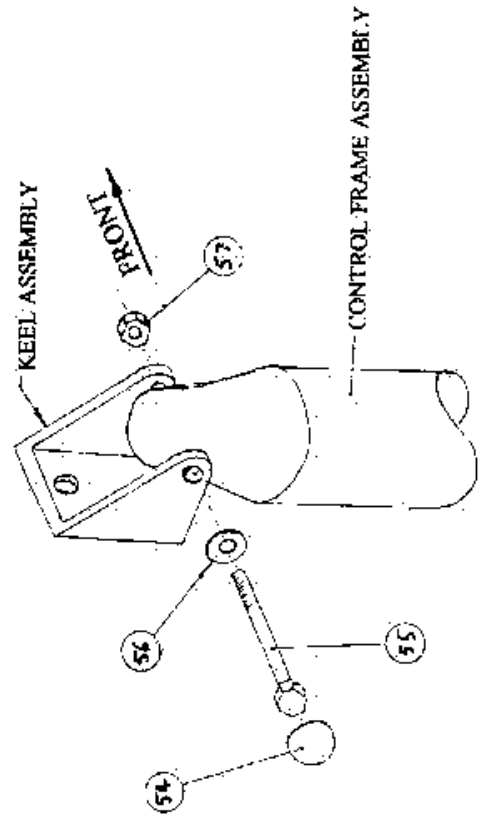
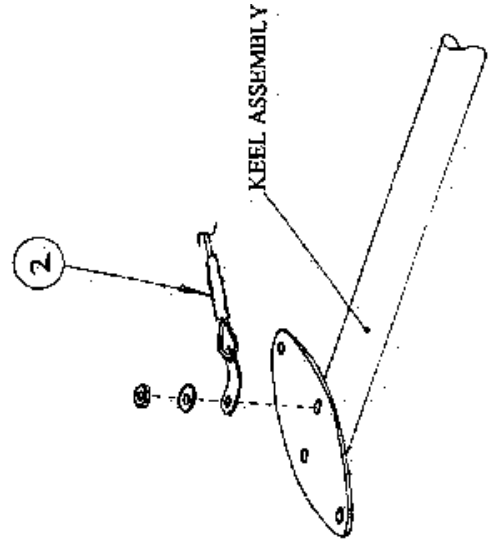
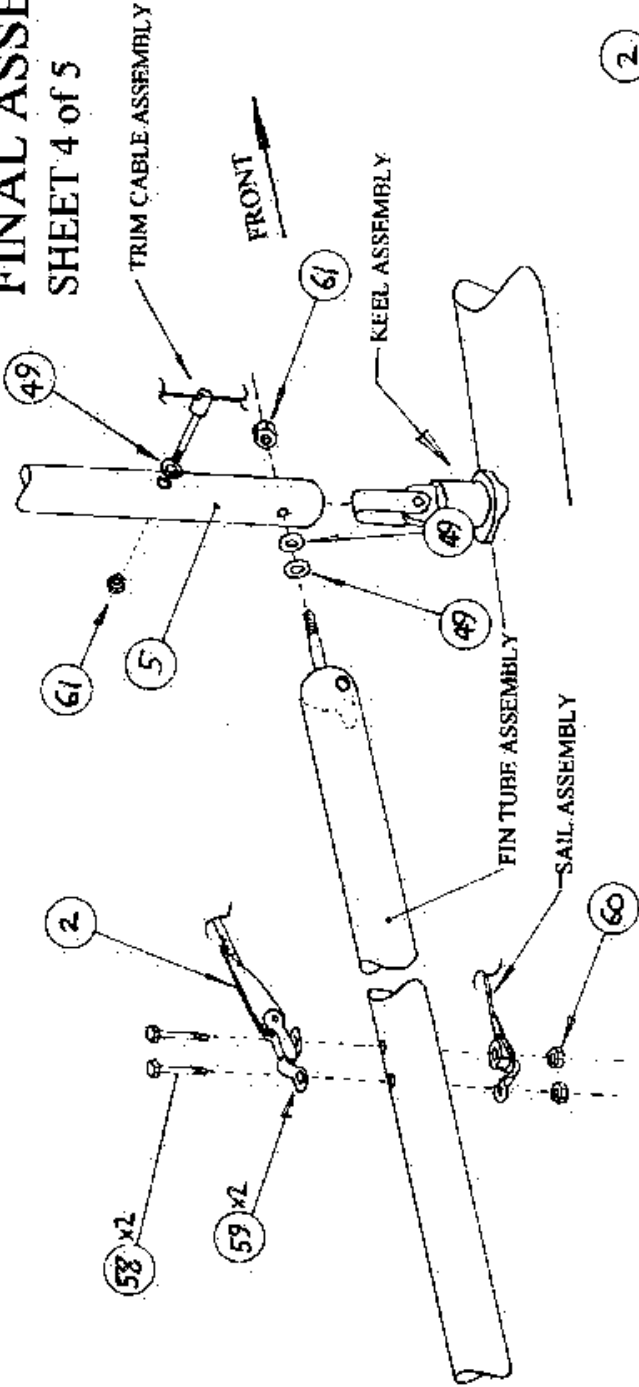

FINAL ASSEMBLY

SHEET 5 of 5

